



ENGINEERING EXCELLENCE

Americana Series #6AM410

PARTS BREAKDOWN SHEET

DESCRIPTION

- Handheld Shower Set
- Single Function Handheld Showerhead
- 60" Stainless Steel Flex Hose
- Wall Mount Bracket with Vacuum Breaker

FINISHES

- PC PVD Polished Chrome
- BN PVD Brushed Nickel
- SS PVD Stainless Steel
- PN PVD Polished Nickel
- PB PVD Polished Brass
- GR PVD Golden Rose
- ORB Oil Rubbed Bronze



STANDARDS APPLICABLE

- ASME A112.18.1
- CUPC / IAPMO LISTED /ADA COMPLIANT
- **Note:-** This Product Complies With ADA Requirement For Lever Handle.

FLOW

- Showerhead Limited to 2.5 GPM

#6AM410 SHOWN * ADA 

Model #: _____

Specific Features: _____

Project Name: _____

Submitted For: _____

Model	Description	Finishes
#6AM410	Handheld Shower Set	<input type="checkbox"/> PC <input type="checkbox"/> Other ____



ENGINEERING EXCELLENCE

Pioneer: 1-800-338-9468
 Commerce, CA 90040
 www.pioneerind.com
 Pioneer Industries, Inc. © 2012

	ITEM#	DESCRIPTION
A	X-4900045*	Handheld Showerhead
B	X-4600006*	60" Stainless Steel Flex Hose
C	X-4600005*	Vacuum Breaker
D	X-4600031*	Drop Ell with Handheld Support
E	X-4600032*	Flange

* Note- Please specify finish\color code while ordering.

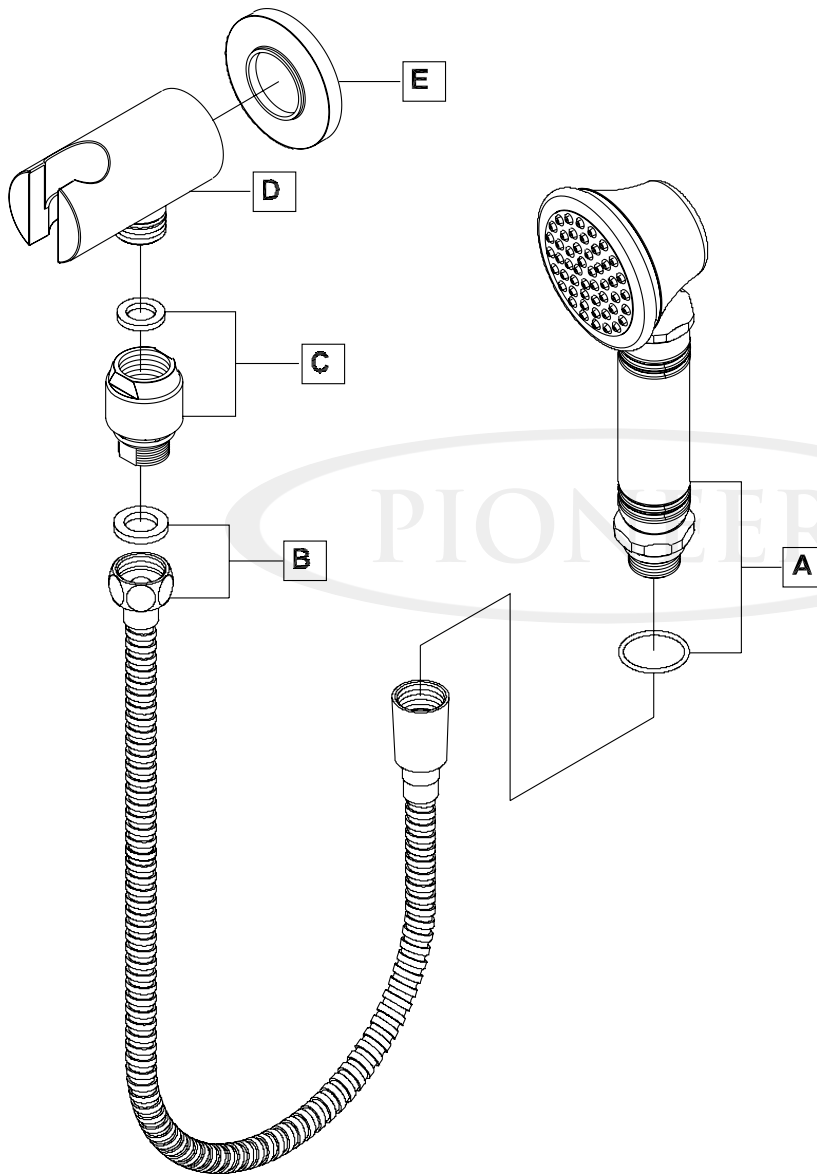

Product Diagram



ENGINEERING EXCELLENCE

Pioneer: 1-800-338-9468
 Commerce, CA 90040
 www.pioneerind.com
 Pioneer Industries, Inc. © 2012