



ENGINEERING EXCELLENCE

Legacy Series #5LG220

PARTS BREAKDOWN SHEET

DESCRIPTION

- Two Handle Bar Faucet
- ADA Wrist Blade Handles
- Gooseneck Spout
- 3-5/8" Reach, 7" From Deck to Aerator
- Ceramic Disc Cartridges
- 2 or 3-Hole 4" Installation

FINISHES

- PC PVD Polished Chrome
- BN PVD Brushed Nickel
- SS PVD Stainless Steel
- PB PVD Polished Brass
- ORB Oil Rubbed Bronze



#5LG220 SHOWN * ADA 

STANDARDS APPLICABLE

- ASME A112.18.1
- ANSI A117.1
- ANSI / NSF 61, SECTION 9
- CUPC / IAPMO LISTED / ADA COMPLIANT
- CONTAINS NO MORE THAN 0.25% WEIGHTED AVERAGE LEAD CONTENT

FLOW

- Aerator Limited to 1.5 GPM

Model #: _____

Specific Features: _____

Project Name: _____

Submitted For: _____

Model	Description	Finishes	
#5LG220	Two Handle Bar Faucet	<input type="checkbox"/> PC	<input type="checkbox"/> Other__



ENGINEERING EXCELLENCE

Pioneer:1-800-338-9468
 Commerce, CA 90040
 www.pioneerind.com
 Pioneer Industries, Inc. © 2013

DMPB5LG220/REV. 12 2012
 Page 1 of 2

	ITEM#	DESCRIPTION
A	X-1900003C,H*	ADA Wrist Blade Handle-Cold,Hot
B	X-4900007	Bonnet Nut
C	X-3900002C	Ceramic Stem - Cold
D	X-3900002H	Ceramic Stem - Hot
E	X-4500002*	Deck Plate
F	X-4500003	Base Plate
G	X-4900008	Mounting Kit
H	X-4900004	Supply Nut
I	X-2500002*	3-5/8" Reach Gooseneck Spout
1	X-4900010*	ADA Wrist Blade Handle Screw
2	X-4900011C,H	ADA Wrist Blade Handle Index-Cold & Hot
3	X-4900084*	1.5 GPM Aerator
4	X-4500001*	Spout Sleeve
5	X-4900013	Spout Snap Ring
6	X-4900012	Spout O-ring

* Note- Please specify finish/color code while ordering.

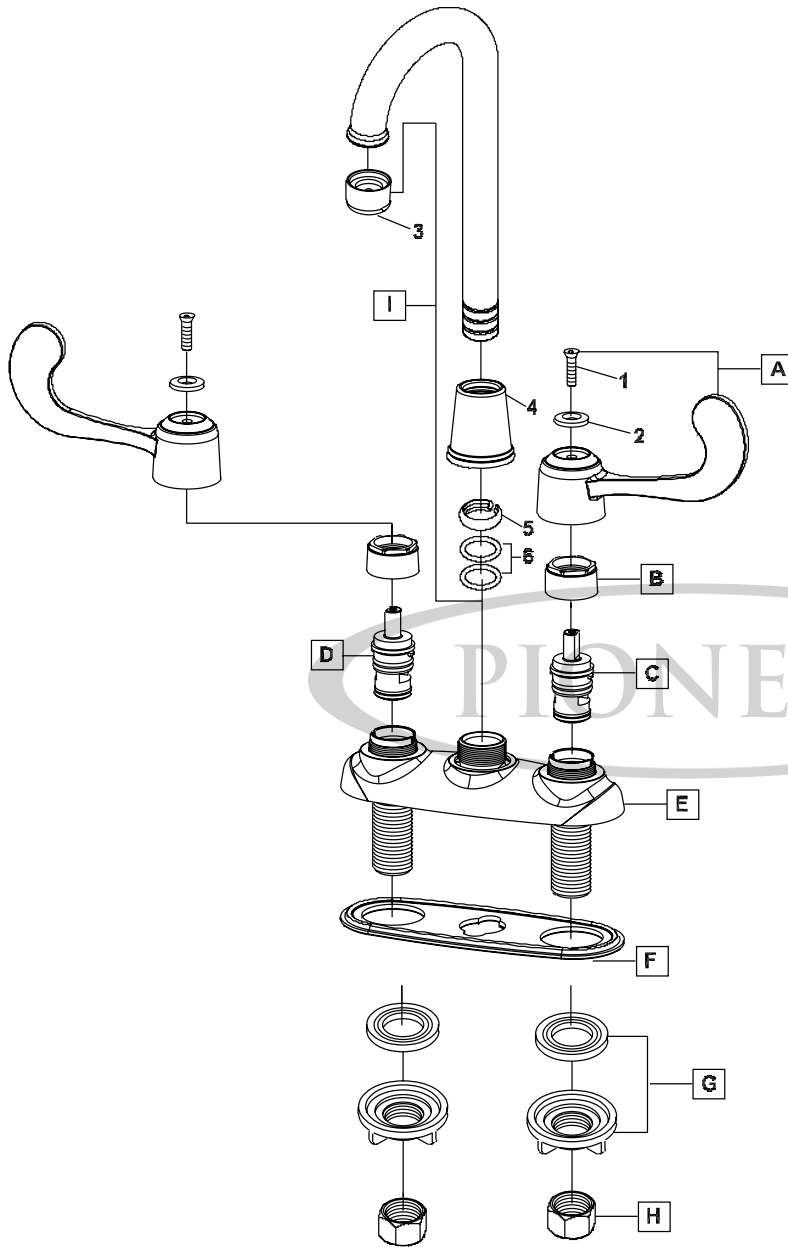

Product Diagram



ENGINEERING EXCELLENCE

Pioneer:1-800-338-9468
 Commerce, CA 90040
 www.pioneerind.com
 Pioneer Industries, Inc. © 2013