



ENGINEERING EXCELLENCE

Motegi Series #2MT341

PARTS BREAKDOWN SHEET

DESCRIPTION

- Single Handle Kitchen Faucet
- Metal Lever Handles
- Spout Swivel 360°
- 8-3/4" Reach, 8-1/2" from Deck to Aerator
- Ceramic Disc Cartridge with Temperature Limit Stop
- 3-Hole 4" to 6" Installation
- Side Spray Assembly

FINISHES

- PC PVD Polished Chrome
- BN PVD Brushed Nickel
- SS PVD Stainless Steel
- PN PVD Polished Nickel
- PB PVD Polished Brass



STANDARDS APPLICABLE

- ASME A112.18.1
- ANSI A117.1
- ANSI / NSF 61, SECTION 9
- CUPC / IAPMO LISTED / ADA COMPLIANT
- CONTAINS NO MORE THAN 0.25% WEIGHTED AVERAGE LEAD CONTENT

FLOW

- Aerator Limited to 1.5 GPM

#2MT341 SHOWN * ADA 

Model #: _____

Specific Features: _____

Project Name: _____

Submitted For: _____

Model	Description	Finishes	
#2MT341	Single Handle Kitchen Faucet	<input type="checkbox"/> PC	<input type="checkbox"/> Other__



ENGINEERING EXCELLENCE

Pioneer:1-800-338-9468
 Commerce, CA 90040
 www.pioneerind.com
 Pioneer Industries, Inc. © 2013

DMPB2MT341/REV. 12 2012

Page 1 of 2

ITEM#	DESCRIPTION
A	X-1900008* Motegi Lever Handle
B	X-4900017* Retainer Sleeve
C	X-4900018 Retainer Nut
D	X-3900001 Ceramic Disc Cartridge
E	X-4900004 Supply Nut
F	X-4200092* Valve Escutcheon
G	X-5900002 Mounting Kit
H	X-4200168 Cap and Washer
I	X-4200025 Cross Connector
J	X-5200003 Spout Mounting Kit
K	X-2200016* Motegi Spout
L	X-4200070* Side Spray Assembly
1	X-4900044* Hole Cover
2	X-4400024 Allen Screw
3	X-4900089* 1.5 GPM Aerator
4	X-4900012 Spout O-Ring
5	X-4200071* Spout Escutcheon
6	X-4200016 Diverter Piston

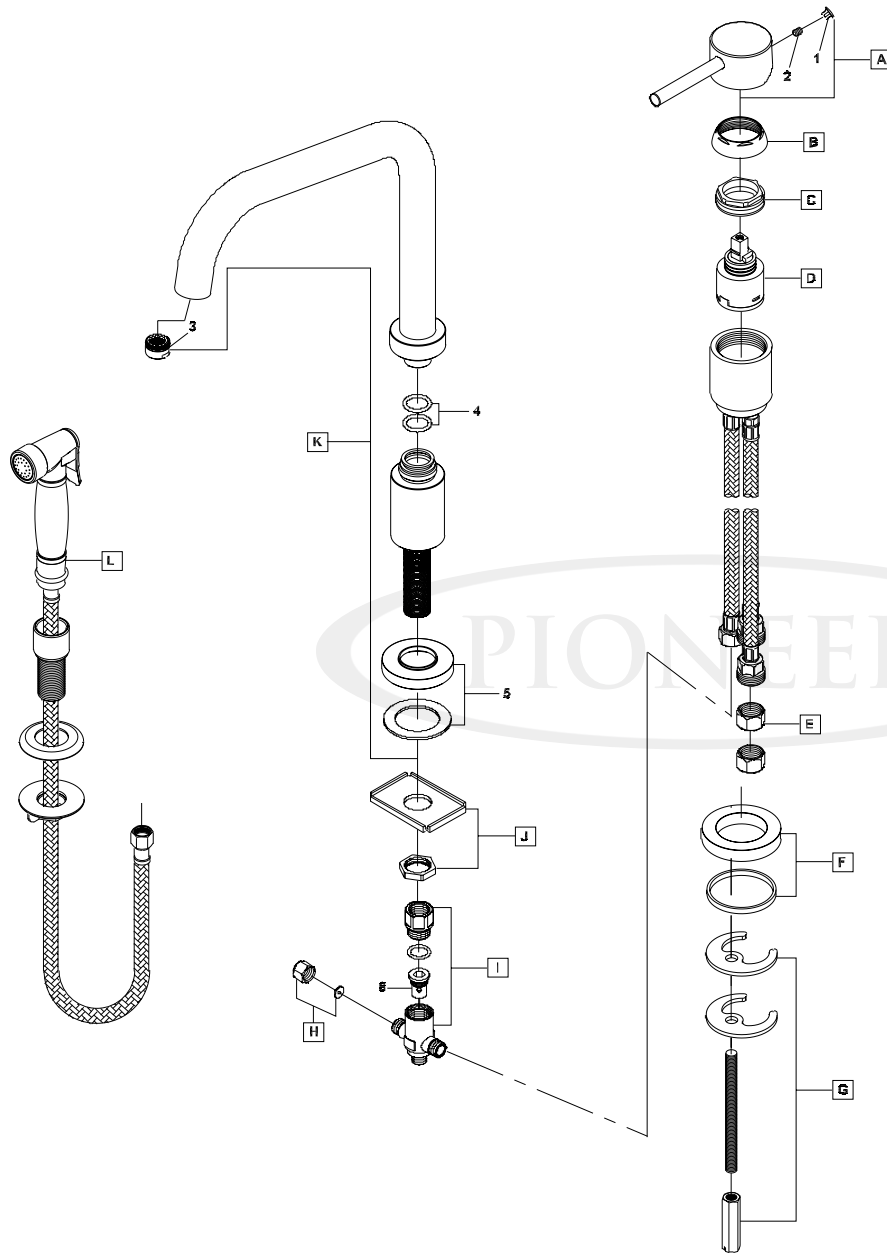

* Note: Please specify finish/color when ordering.

Product Diagram



ENGINEERING EXCELLENCE

Pioneer: 1-800-338-9468
 Commerce, CA 90040
 www.pioneerind.com
 Pioneer Industries, Inc. © 2013