



ENGINEERING EXCELLENCE

Legacy Series #2LG320

PARTS BREAKDOWN SHEET

DESCRIPTION

- Two Handle Kitchen Wide-spread Faucet
- ADA Wrist Blade Handles
- Legacy Series Gooseneck Spout
- 8" Reach, 6-5/8" from Deck to Aerator
- Ceramic Disc Cartridges
- 3-Hole 8" to 20" Installation
- Vandal Resistant Aerator

FINISHES

- PC PVD Polished Chrome



#2LG320 SHOWN * ADA



FLOW

- Aerator Limited to 2.0 gpm

STANDARDS APPLICABLE

- ASME A112.18.1
- ANSI A117.1
- ANSI / NSF 61, SECTION 9
- CUPC / IAPMO LISTED / ADA COMPLIANT
- CONTAINS NO MORE THAN 0.25% WEIGHTED AVERAGE LEAD CONTENT

Model #: _____

Specific Features: _____

Project Name: _____

Submitted For: _____

Model	Description	Finishes	
#2LG320	Two Handle Kitchen Faucet	PC	Other__



ENGINEERING EXCELLENCE

Pioneer:1-800-338-9468
 Commerce, CA 90040
 www.pioneerind.com
 Pioneer Industries, Inc. © 2010

DMPB2LG320/REV. 10 2010
 Page 1 of 2

	ITEM#	DESCRIPTION
A	X-1200016C,H	ADA Wrist Blade Handle-Cold,Hot
B	X-4200024	Valve Escutcheon
C	X-4900022	Bonnet Nut
D	X-3900002C	Ceramic Disc Cartridge-Cold
E	X-3900002H	Ceramic Disc Cartridge-Hot
F	X-5900001	Mounting Kit
G	X-4900004	Supply Nut
H	X-4900021	Hose </td
I	X-4300011	'Y' Connector
J	X-5300003	Spout Mounting Kit
K	X-2200024	Gooseneck Spout
1	X-4200026	Screw
2	X-4900011C,H	Index Button-Cold,Hot
3	X-4200089	2.0 GPM Aerator
4	X-4200111	Spout Flange
5	X-4900013	Snap Ring
6	X-4900012	O-Ring
7	X-4200112	Spout Escutcheon

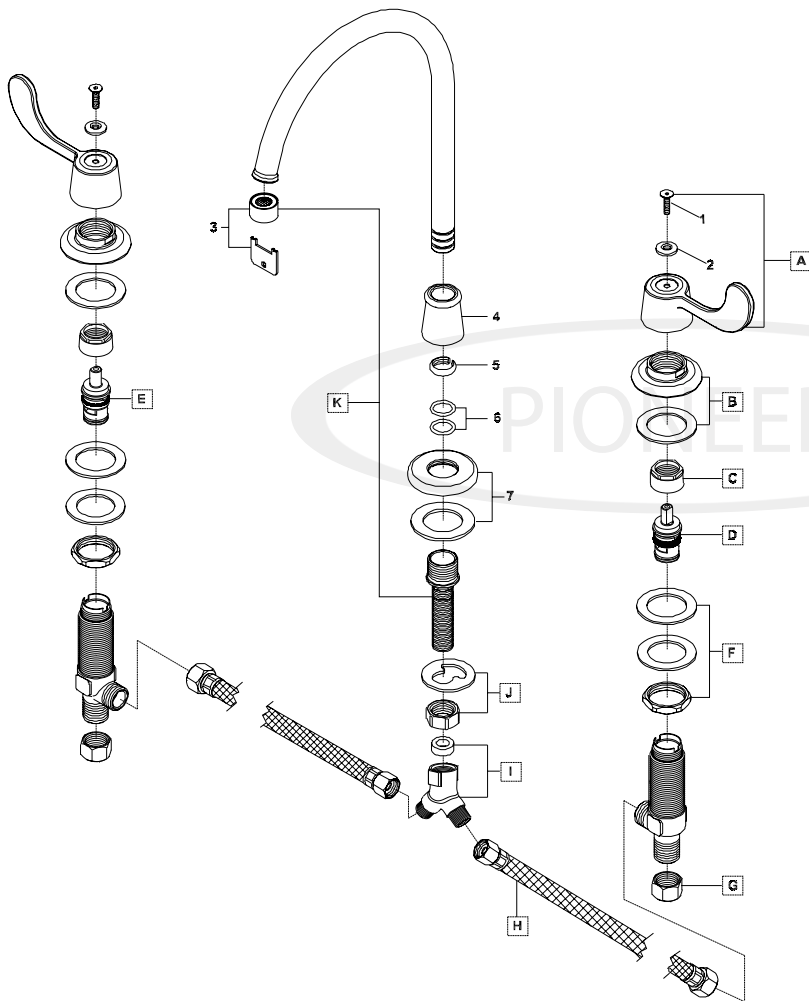

Product Diagram



ENGINEERING EXCELLENCE

Pioneer:1-800-338-9468
 Commerce, CA 90040
 www.pioneerind.com
 Pioneer Industries, Inc. © 2010