



# ENGINEERING EXCELLENCE

Legacy Series #2LG271

PARTS BREAKDOWN SHEET

### DESCRIPTION

- Single Handle Kitchen Faucet
- Metal Loop Handle
- Spout Swivel 360°
- 9-11/16" Reach, 5-7/8" From Deck to Aerator
- Ceramic Disc Cartridge with Temperature Limit Stop
- 2 Hole Installation
- Side Spray Assembly

### FINISHES

- PC PVD Polished Chrome
- BN PVD Brushed Nickel



#2LG271 SHOWN \* ADA 

### STANDARDS APPLICABLE

- ASME A112.18.1
- ANSI A117.1
- ANSI / NSF 61, SECTION 9
- CUPC / IAPMO LISTED / ADA COMPLIANT
- CONTAINS NO MORE THAN 0.25% WEIGHTED AVERAGE LEAD CONTENT

### FLOW

- Aerator Limited to 1.5 GPM

Model #: \_\_\_\_\_

Specific Features: \_\_\_\_\_

Project Name: \_\_\_\_\_

Submitted For: \_\_\_\_\_

| Model   | Description                  | Finishes                    |                                  |
|---------|------------------------------|-----------------------------|----------------------------------|
| #2LG271 | Single Handle Kitchen Faucet | <input type="checkbox"/> PC | <input type="checkbox"/> Other__ |



ENGINEERING EXCELLENCE

Pioneer: 1-800-338-9468  
 Commerce, CA 90040  
 www.pioneerind.com  
 Pioneer Industries, Inc. © 2013

DMPB2LG271/REV. 12 2012  
 Page 1 of 2

|   | ITEM#      | DESCRIPTION            |
|---|------------|------------------------|
| A | X-1200002* | Legacy Loop Handle     |
| B | X-4200001* | Retainer Cap           |
| C | X-4200002  | Retainer Nut           |
| D | X-3900001  | Ceramic Disc Cartridge |
| E | X-4200003  | Spout Gasket           |
| F | X-2200001* | Legacy Spout           |
| G | X-4200004  | O-Ring                 |
| H | X-4200007  | Diverter Piston        |
| I | X-4200109* | Escutcheon             |
| J | X-4200110  | Washer                 |
| K | X-5200015  | Mounting Kit           |
| L | X-4900004  | Supply Nut             |
| M | X-4200008* | Side Spray             |
| 1 | X-4900001  | Hot & Cold Indicator   |
| 2 | X-4900002  | Allen Screw            |
| 3 | X-4900081* | 1.5 GPM Aerator        |

\* Note- Please specify finish/color code while ordering.

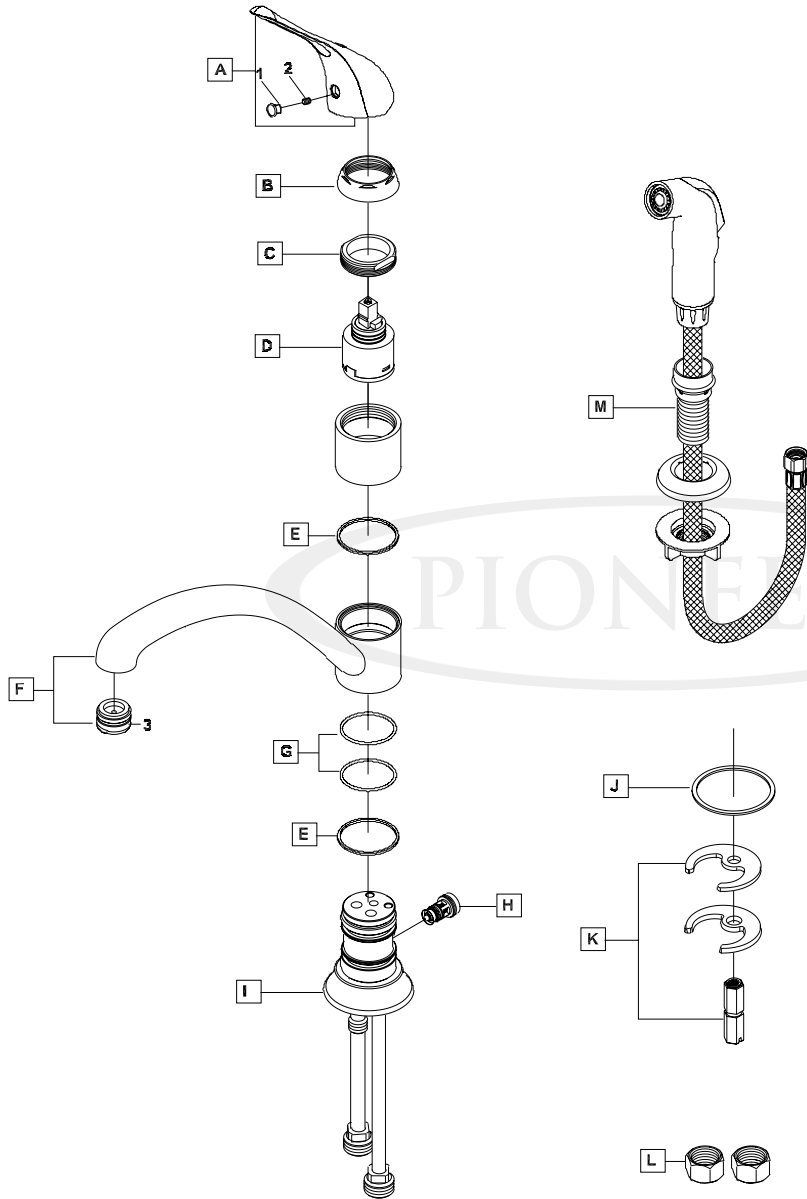

Product Diagram



ENGINEERING EXCELLENCE

Pioneer:1-800-338-9468  
 Commerce, CA 90040  
 www.pioneerind.com  
 Pioneer Industries, Inc. © 2013