



ENGINEERING EXCELLENCE

Caesar Collection #2CS331

PARTS BREAKDOWN SHEET

DESCRIPTION

- Single Handle Kitchen Faucet
- Metal Lever Handle
- Spout Swivel 360°
- 9" Reach, 7-7/8" from Deck to Aerator
- Ceramic Disc Cartridge with Temperature Limit Stop
- 3-Hole 4" to 23" Installation
- Side Spray Assembly

FINISHES

- PC PVD Polished Chrome
- BN PVD Brushed Nickel
- SS PVD Stainless Steel
- PN PVD Polished Nickel
- GR PVD Golden Rose



#2CS331 SHOWN * ADA 

STANDARDS APPLICABLE

- ASME A112.18.1
- ANSI A117.1
- ANSI / NSF 61, SECTION 9
- CUPC / IAPMO LISTED / ADA COMPLIANT
- CONTAINS NO MORE THAN 0.25% WEIGHTED AVERAGE LEAD CONTENT

FLOW

- Aerator Limited to 1.5 GPM

Model #: _____

Specific Features: _____

Project Name: _____

Submitted For: _____

Model	Description	Finishes	
#2CS331	Single Handle Kitchen Faucet	<input type="checkbox"/> PC	<input type="checkbox"/> Other__



ENGINEERING EXCELLENCE

Pioneer:1-800-338-9468

Commerce, CA 90040

www.pioneerind.com

Pioneer Industries, Inc. © 2013

DMPB2CS331/REV. 12 2012

Page 1 of 2

	ITEM#	DESCRIPTION
A	X-1900016*	Caesar Handle
B	X-4900058*	Retainer Sleeve
C	X-4200135	Retainer Nut
D	X-4200136	Washer
E	X-3200007	Ceramic Disc Cartridge
F	X-4900004	Supply Nut
G	X-4200137	Gasket
H	X-5200016	Mounting Kit
I	X-5200005	Mounting Tool
J	X-5900006	Mounting Tool
K	X-4200168	Cap and Washer
L	X-4200025	Cross Connector
M	X-5200003	Mounting Kit
N	X-2200026*	Caesar Spout
O	X-4200141*	Caesar Side Spray Assembly
1	X-4900044*	Hole Cover
2	X-4400024	3/32" Allen Screw
3	X-4200016	Diverter Piston
4	X-4200139*	Spout Flange
5	X-4200140	Gasket
6	X-4900081*	1.5 GPM Flow Rate Aerator

* Note: Please specify finish/color when ordering.

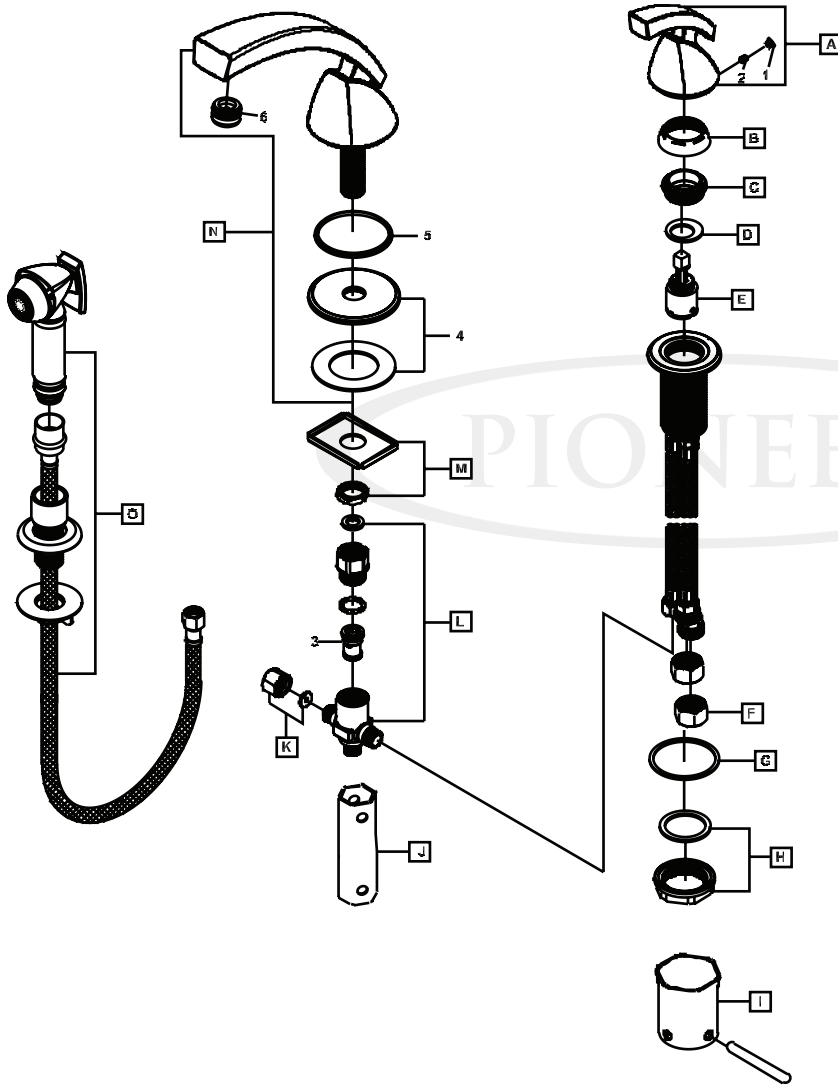

Product Diagram



ENGINEERING EXCELLENCE

Pioneer: 1-800-338-9468
 Commerce, CA 90040
 www.pioneerind.com
 Pioneer Industries, Inc. © 2013