



ENGINEERING EXCELLENCE

Del Mar Series #6DM920

PARTS BREAKDOWN SHEET

DESCRIPTION

- Handheld Shower Set
- Metal Lever Handle
- Two Way Diverter Valve
- Deck or Ledge Mount
- Single Function Handheld Showerhead
- Anti-Backflow Device
- 60" Stainless Steel Flex Hose

FINISHES

- PC PVD Polished Chrome
- BN PVD Brushed Nickel
- PN PVD Polished Nickel
- TB PVD Tuscany Bronze



STANDARDS APPLICABLE

- ASME A112.18.1
- ANSI A117.1
- ADA COMPLIANT

FLOW

- Showerhead Limited to 2.5 GPM

#6DM920 SHOWN * ADA

NOTE :- There is more than 1 Versions of this Product. Page down to identify the version you have.

Model #: _____

Specific Features: _____

Project Name: _____

Submitted For: _____

Model	Description	Finishes	
#6DM920	Handheld Shower Set	<input type="checkbox"/> PC	<input type="checkbox"/> Other__



ENGINEERING EXCELLENCE
 Pioneer:1-800-338-9468
 Commerce, CA 90040
 www.pioneerind.com
 Pioneer Industries, Inc. © 2013

DMPB6DM920/REV. 12 2012
 Page 1 of 3

	ITEM#	DESCRIPTION
A	X-1400002*	Del Mar Lever Handle
B	X-4900024	3/32" Allen Wrench
C	X-4600021*	Valve Escutcheon
D	X-5600003	Valve Mounting Kit
E	X-4600022	Handle Adapter
F	X-3600002	Diverter Stem
G	X-4600041	Check Valve
H	X-4600006*	60" Stainless Steel Flex Hose
I	X-5600004	Mounting Kit
J	X-4600024*	Showerhead Holder
K	X-4600008*	Del Mar Handheld Shower
1	X-4900002	3/32" Allen Screw
2	X-4900068	O-Ring

* Note- Please specify finish/color code while ordering.

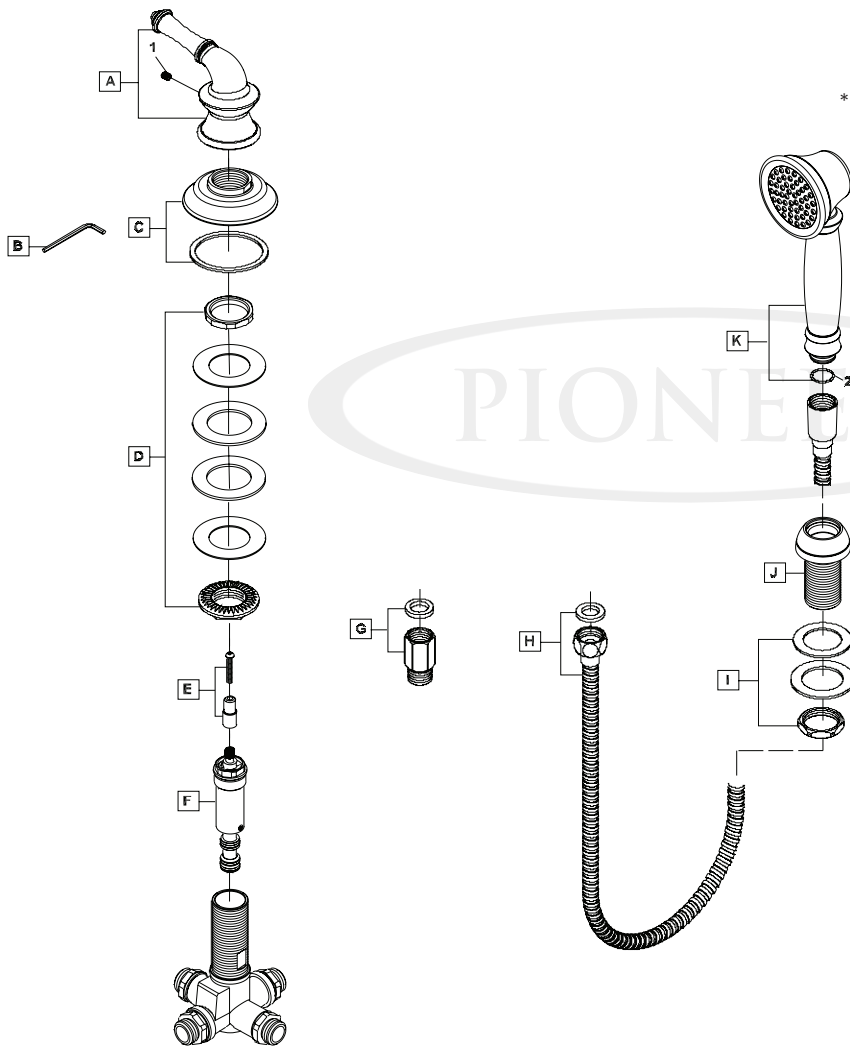

Product Diagram



	ITEM#	DESCRIPTION
A	X-1400002*	Del Mar Lever Handle
B	X-4900024	3/32" Allen Wrench
C	X-4400014*	Valve Escutcheon
D	X-4600037	Valve Mounting Kit
E	X-3600004	Ceramic Cartridge Assembly
F	X-4600023	Spout Adapter
G	X-4600041	Check Valve
H	X-4600006*	60" Stainless Steel Flex Hose
I	X-5600004	Mounting Kit
J	X-4600024*	Showerhead Holder
K	X-4600008*	Del Mar Handheld Shower
1	X-4900002	3/32" Allen Screw

* Note- Please specify finish/color code while ordering.

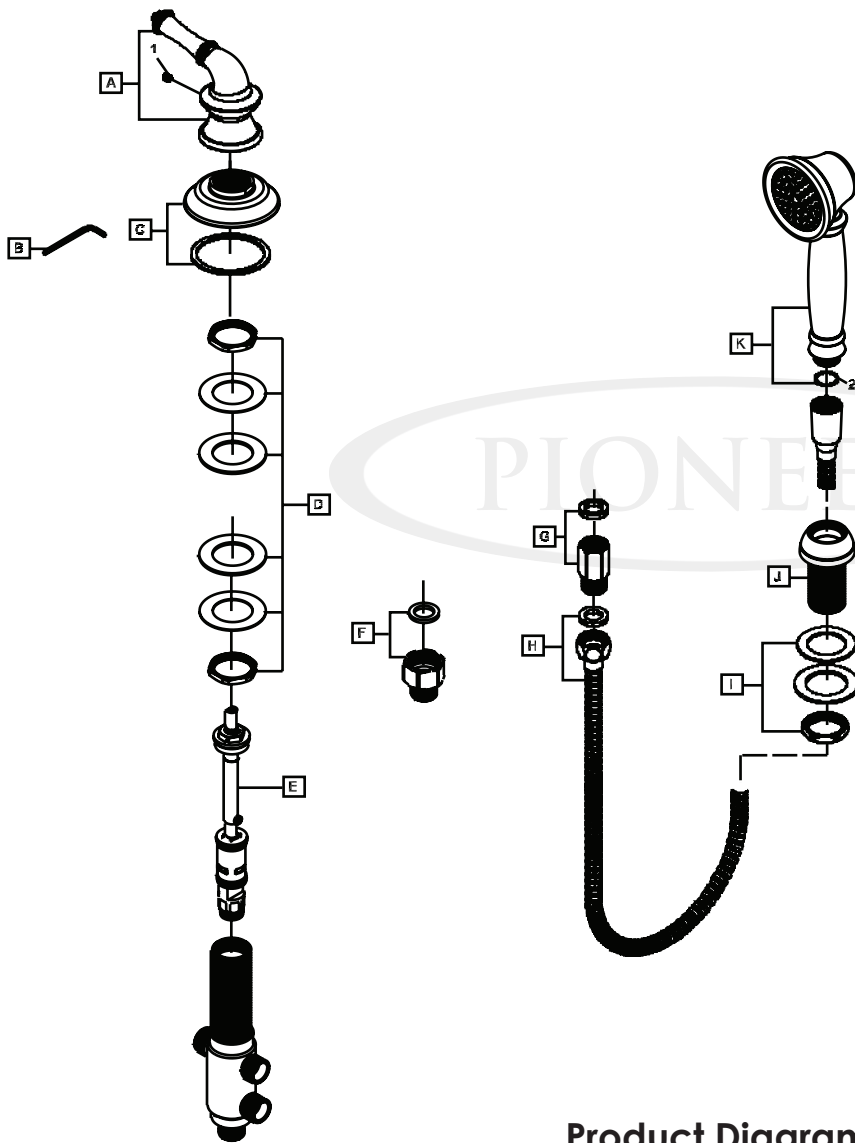

Product Diagram

