



# ENGINEERING EXCELLENCE

Legacy Series #5LG120

PARTS BREAKDOWN SHEET

### DESCRIPTION

- Two Handle Bar Faucet
- ADA Wrist Blade Handles
- Gooseneck Spout Swivel 360°
- 5-3/16" Reach, 5-7/8" From Deck to Aerator
- Ceramic Disc Cartridges
- 2 or 3-Hole 4" Installation

### FINISHES

- PC PVD Polished Chrome
- SS PVD Stainless Steel
- BN PVD Brushed Nickel
- PB PVD Polished Brass
- ORB Oil Rubbed Bronze



#5LG120 SHOWN \* ADA 

### STANDARDS APPLICABLE

- ASME A112.18.1
- ANSI A117.1
- ANSI / NSF 61, SECTION 9
- CUPC / IAPMO LISTED / ADA COMPLIANT
- CONTAINS NO MORE THAN 0.25% WEIGHTED AVERAGE LEAD CONTENT

### FLOW

- Aerator Limited to 1.5 GPM

Model #: \_\_\_\_\_

Specific Features: \_\_\_\_\_

Project Name: \_\_\_\_\_

Submitted For: \_\_\_\_\_

Model	Description	Finishes	
#5LG120	Two Handle Bar Faucet	<input type="checkbox"/> PC	<input type="checkbox"/> Other__



ENGINEERING EXCELLENCE

Pioneer:1-800-338-9468  
 Commerce, CA 90040  
 www.pioneerind.com  
 Pioneer Industries, Inc. © 2012

DMPB5LG120/REV. 12 2012  
 Page 1 of 2

	ITEM#	DESCRIPTION
A	X-1900003C,H*	ADA Wrist Blade Handle-Cold,Hot
B	X-4900007	Bonnet Nut
C	X-3900002C	Ceramic Stem - Cold
D	X-3900002H	Ceramic Stem - Hot
E	X-4500002*	Deck Plate
F	X-4500003	Base Plate
G	X-4900008	Mounting Kit
H	X-4900004	Supply Nut
I	X-2500001*	5-3/16" Reach Gooseneck Spout
1	X-4900010*	Wrist Blade Handle Screw
2	X-4900011C,H	Wrist Blade Handle Index-Cold & Hot
3	X-4900084*	1.5 GPM Aerator
4	X-4500001*	Spout Sleeve
5	X-4900013	Spout Snap Ring
6	X-4900012	Spout O-ring

\* Note- Please specify finish/color code while ordering.

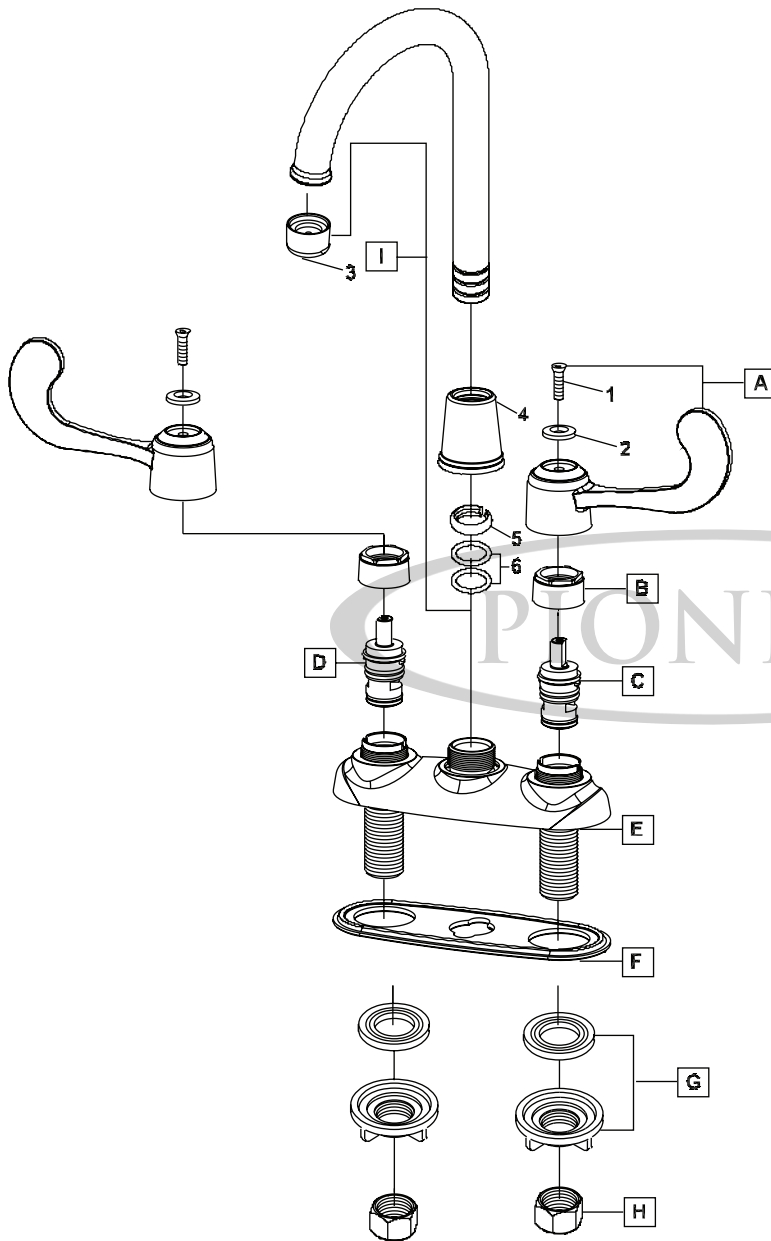

Product Diagram



ENGINEERING EXCELLENCE

Pioneer:1-800-338-9468  
 Commerce, CA 90040  
 www.pioneerind.com  
 Pioneer Industries, Inc. © 2012