



ENGINEERING EXCELLENCE

#4300B

PARTS BREAKDOWN SHEET

DESCRIPTION

- Two Handle Roman Tub Valve Set
- 1/2" IPS Connections
- Quick Mount Connector
- Deck or Ledge Mount
- Ceramic Disc Cartridges
- 3-Hole 8" to 16" Installation
- Brass Plug, Valve Stem Extension
- 12" SS Flex Hose, Mud Guards Included

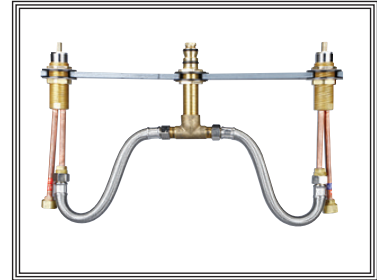

#4300B SHOWN

STANDARDS APPLICABLE

- ASME A112.18.1

Model #: _____

Specific Features: _____

Project Name: _____

Submitted For: _____

Model	Description	Finishes
#4300B	Two Handle Roman Tub Valve Set	<input type="checkbox"/> NA



ENGINEERING EXCELLENCE

Pioneer: 1-800-338-9468
 Commerce, CA 90040
 www.pioneerind.com
 Pioneer Industries, Inc. © 2013

DMPB4300B/REV. 12 2012
 Page 1 of 2

	ITEM#	DESCRIPTION
A	X-5400003	Valve Mounting Kit
B	X-3900005C	Valve-Cold
C	X-3900005H	Valve-Hot
D	X-4900004	Supply Nut
E	X-4400063	Hose </td
F	X-4400029	T-Connector
G	X-5400006	Spout Mounting Kit
H	X-5400005	Spout Shank and Test Cap
1	X-4900022	Bonnet Nut
2	X-3900002C	Ceramic Disc Cartridge-Cold
3	X-3900002H	Ceramic Disc Cartridge-Hot

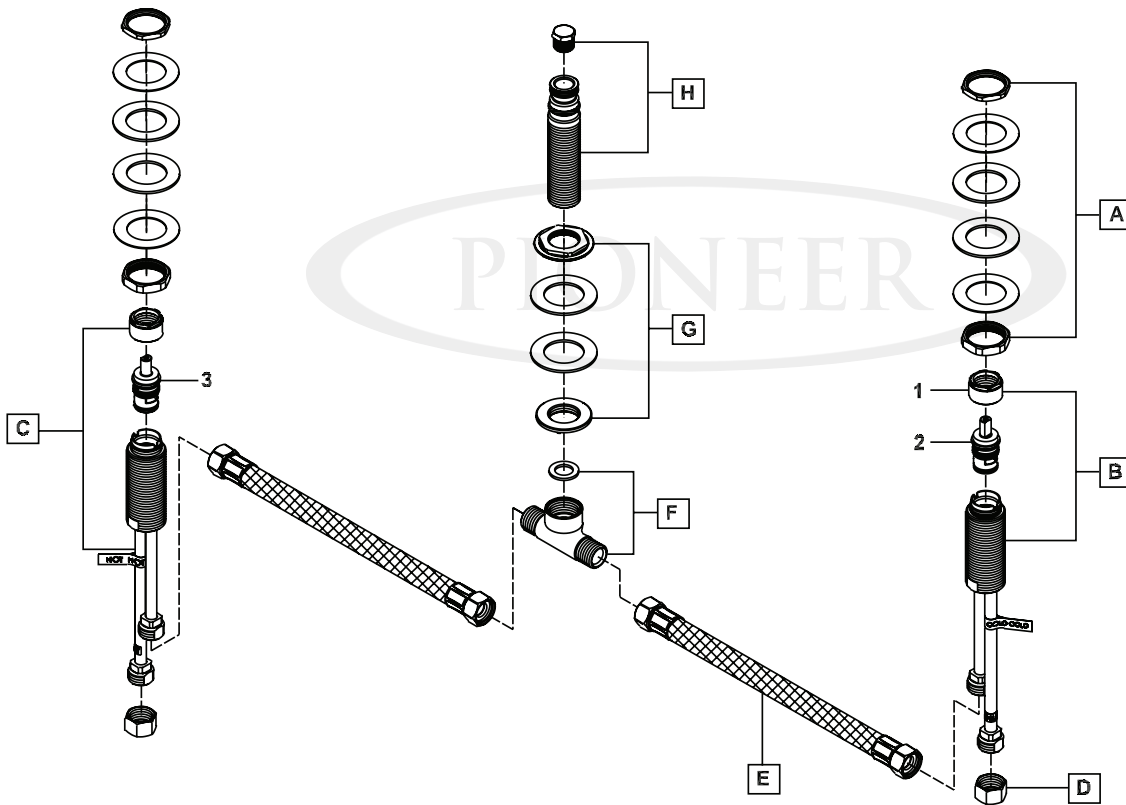

Product Diagram



ENGINEERING EXCELLENCE

Pioneer: 1-800-338-9468

Commerce, CA 90040

www.pioneerind.com

Pioneer Industries, Inc. © 2013