



ENGINEERING EXCELLENCE

Prenza Series #3PR200

PARTS BREAKDOWN SHEET

DESCRIPTION

- Two Handle Lavatory Wide-spread Faucet
- Metal Lever Handles
- 5-3/16" Reach, 4" from Deck to Aerator
- Ceramic Disc Cartridges
- 3-Hole 6" to 16" Installation
- Brass Pop-Up Drain Assembly

FINISHES

- PC PVD Polished Chrome
- BN PVD Brushed Nickel
- SS PVD Stainless Steel
- PN PVD Polished Nickel



STANDARDS APPLICABLE

- ASME A112.18.1
- ANSI A117.1
- ANSI / NSF 61, SECTION 9
- CUPC / IAPMO LISTED / ADA COMPLIANT
- CONTAINS NO MORE THAN 0.25% WEIGHTED AVERAGE LEAD CONTENT

FLOW

- Aerator Limited to 1.5 GPM

#3PR200 SHOWN * ADA 



Model #: _____

Specific Features: _____

Project Name: _____

Submitted For: _____

Model	Description	Finishes	
#3PR200	Two Handle Lavatory Widespread Faucet	<input type="checkbox"/> PC	<input type="checkbox"/> Other__



ENGINEERING EXCELLENCE

Pioneer:1-800-338-9468
 Commerce, CA 90040
 www.pioneerind.com
 Pioneer Industries, Inc. © 2013

DMPB3PR200/REV. 12 2012
 Page 1 of 2

	ITEM#	DESCRIPTION
A	X-1900014*	Prenza Handle
B	X-4900046	Handle Locknut
C	X-4900053	Stem Extension
D	X-5900004	Valve Mounting Kit
E	X-4900022	Bonnet Nut
F	X-3900002C,H	Ceramic Stem - Cold, Hot
G	X-5900005	Valve Mounting Kit
H	X-4900004	Supply Nut
I	X-4300011	'Y' Connector
J	X-5300003	Spout Mounting Kit
K	X-2300011*	Spout
L	X-4900077	Mounting Tool
M	X-6300015*	Brass Pop-Up Drain Assembly
1	X-4300055*	1.5 GPM Aerator
2	X-4300053*	Spout Escutcheon

* Note- Please specify finish/color code while ordering.

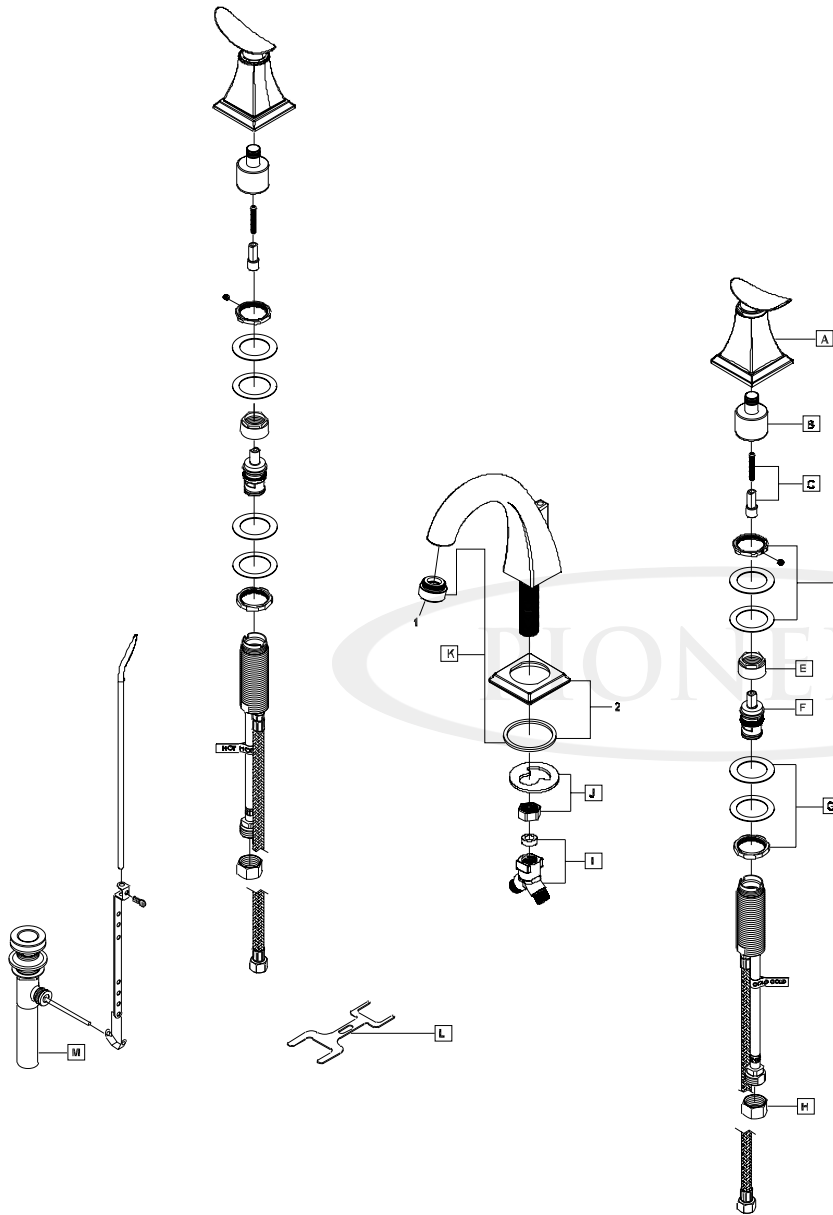

Product Diagram



ENGINEERING EXCELLENCE

Pioneer: 1-800-338-9468
 Commerce, CA 90040
 www.pioneerind.com
 Pioneer Industries, Inc. © 2013