



ENGINEERING EXCELLENCE

Motegi Series #3MT110

PARTS BREAKDOWN SHEET

DESCRIPTION

- Two Handle Lavatory Faucet
- Metal Lever Handles
- Straight Spout
- 3-5/8" Reach, 4-1/8" from Deck to Aerator
- Ceramic Disc Cartridges
- 3-Hole 4" Installation
- Brass Pop-Up Drain Assembly

FINISHES

- PC PVD Polished Chrome
- BN PVD Brushed Nickel
- SS PVD Stainless Steel
- PN PVD Polished Nickel
- PB PVD Polished Brass



STANDARDS APPLICABLE

- ASME A112.18.1
- ANSI A117.1
- ANSI / NSF 61, SECTION 9
- CUPC / IAPMO LISTED / ADA COMPLIANT
- CONTAINS NO MORE THAN 0.25% WEIGHTED AVERAGE LEAD CONTENT

FLOW

- Aerator Limited to 1.5 GPM

#3MT110 SHOWN * ADA 



Model #: _____

Specific Features: _____

Project Name: _____

Submitted For: _____

| Model | Description | Finishes | |
|---------|----------------------------|-----------------------------|----------------------------------|
| #3MT110 | Two Handle Lavatory Faucet | <input type="checkbox"/> PC | <input type="checkbox"/> Other__ |



ENGINEERING EXCELLENCE

Pioneer:1-800-338-9468
 Commerce, CA 90040
 www.pioneerind.com
 Pioneer Industries, Inc. © 2013

DMPB3MT110/REV. 12 2012
 Page 1 of 2

| | ITEM# | DESCRIPTION |
|---|--------------|----------------------------|
| A | X-4900024 | 3/32" Allen Wrench |
| B | X-1300005* | Motegi Series Handle |
| C | X-4900007 | Bonnet Nut |
| D | X-3900002C,H | Ceramic Cartridge-Cold,Hot |
| E | X-4900089* | 1.5 GPM Aerator |
| F | X-4300023 | Base Gasket |
| G | X-4900008 | Mounting Kit |
| H | X-4900004 | Supply Nut |
| I | X-6300006* | Brass Pop-Up Drain |
| 1 | X-4900044* | Hole Cover |
| 2 | X-4900002 | 3/32" Allen Screw |

* Note: Please specify finish/color when ordering.

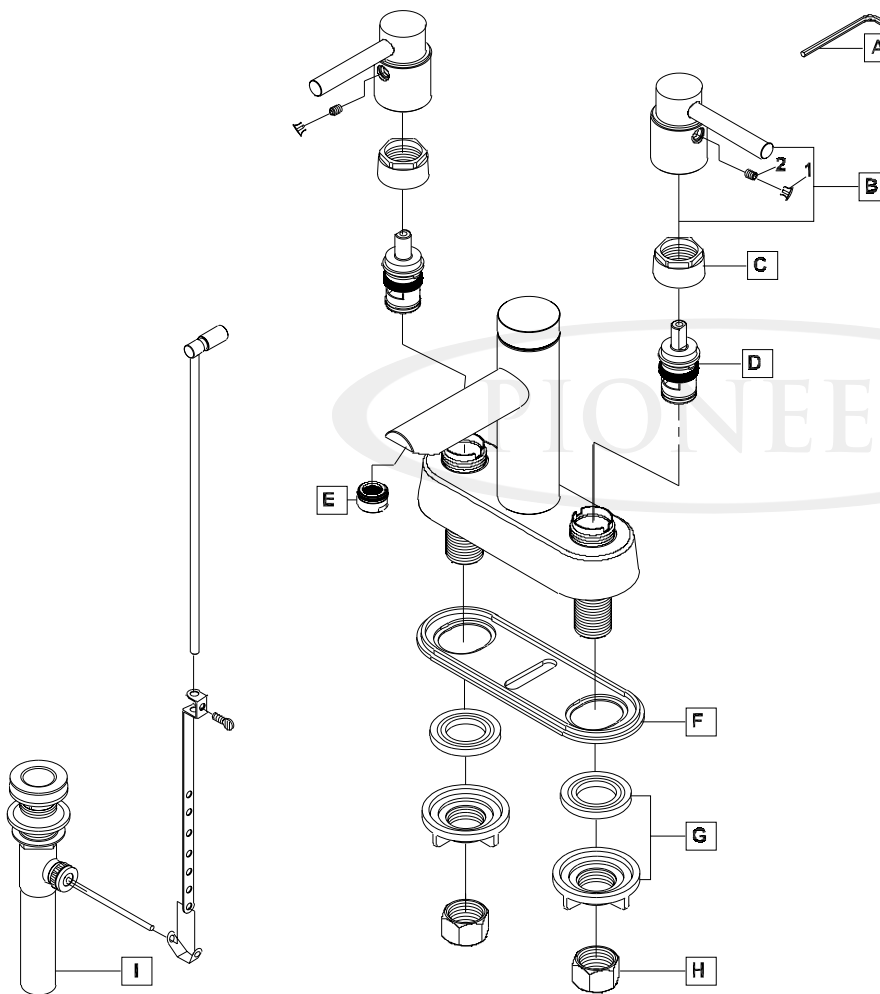

Product Diagram



ENGINEERING EXCELLENCE

Pioneer: 1-800-338-9468
 Commerce, CA 90040
 www.pioneerind.com
 Pioneer Industries, Inc. © 2013