



ENGINEERING EXCELLENCE

Installation Guide

Two Handle Kitchen Widespread Faucet:

- 2LG320

This product meets the following standards:

- ASME A112.18.1
- ANSI A117.1
- ANSI / NSF 61, SECTION 9
- CUPC / IAPMO LISTED / ADA COMPLIANT
- CONTAINS NO MORE THAN 0.25% WEIGHTED AVERAGE LEAD CONTENT

Thank you for purchasing this Pioneer quality product.

Tools Required

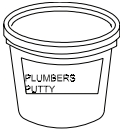

Plumbers Putty

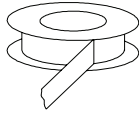

Teflon Tape

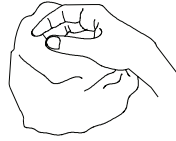

Rags

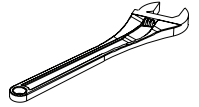

Adjustable-
Wrench

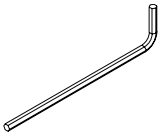

3/32" Allen
Wrench



Flex Hose

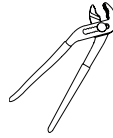

Wrench

Prior to Installation

- Observe all local plumbing and building codes before you begin installation.
- Carefully shut off both hot and cold water supplies from under the sink.
- Plug the sink drain with a soft cloth to prevent intrusion of debris or the loss of any faucet parts.
- For replacement installations, carefully remove the existing faucet and clean the entire surface of the sink mounting holes.
- Pioneer reserves the right to make changes in the design of faucets without notice as specified in the pricebook.

Faucet Installation

1. Ensure the washer(B) is placed underside of the spout(A). Slide the spout (A) through center mounting hole.
 2. Slide the mounting bracket (C) through spout shank from underside of center mounting hole.
 3. Thread and tighten the spout mounting nut (D). Do not overtighten.
 4. Remove any access plumbers putty if used.
- **Note:** The Spout(A) is supplied with washer(B) to form watertight seal. Do not use washer(B) and plumbers putty both to form watertight seal.

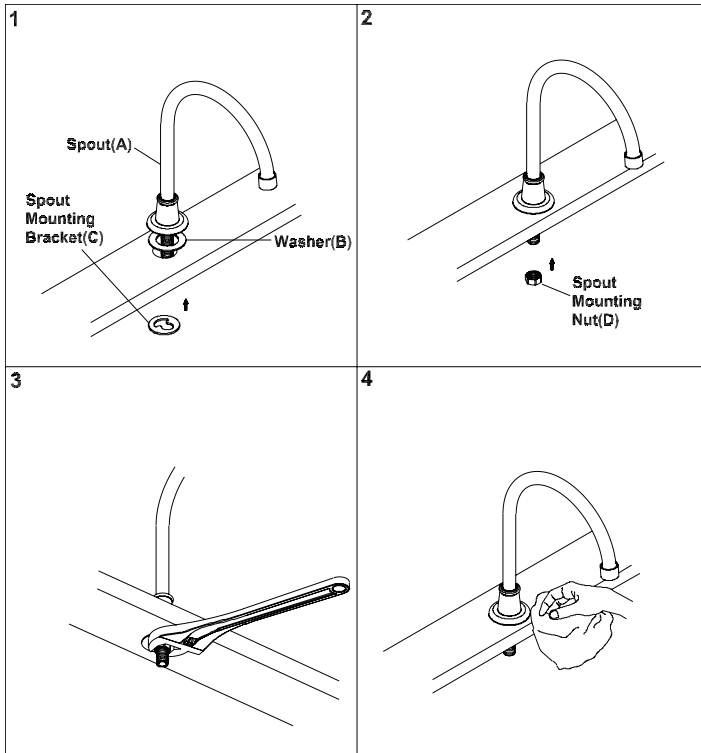

Faucet Installation

- **Note:** The valve escutcheon (H) is supplied with washer(I) to form watertight seal. Do not use washer(I) and plumbers putty both to form watertight seal.
5. Place the escutcheon (H) from the top. Ensure the washer(I) is beneath the escutcheon (H). The hot side valve should have 'HOT' and the cold side should have 'COLD' markings. Place the cold side valve with washers (J & K) and locknut (L) from under the sink.
 6. Thread the escutcheon (H) on the valve. Adjust the valve to proper height.
 7. Install the handle (G) on the valve. Ensure the handle (G) moves in correct direction and it is secure on the valve. Make sure the valve outlet faces toward the spout.
 8. Install the hot side valve, handle and escutcheon same as cold side valve.
 9. Tighten the locknut(L) from underneath.

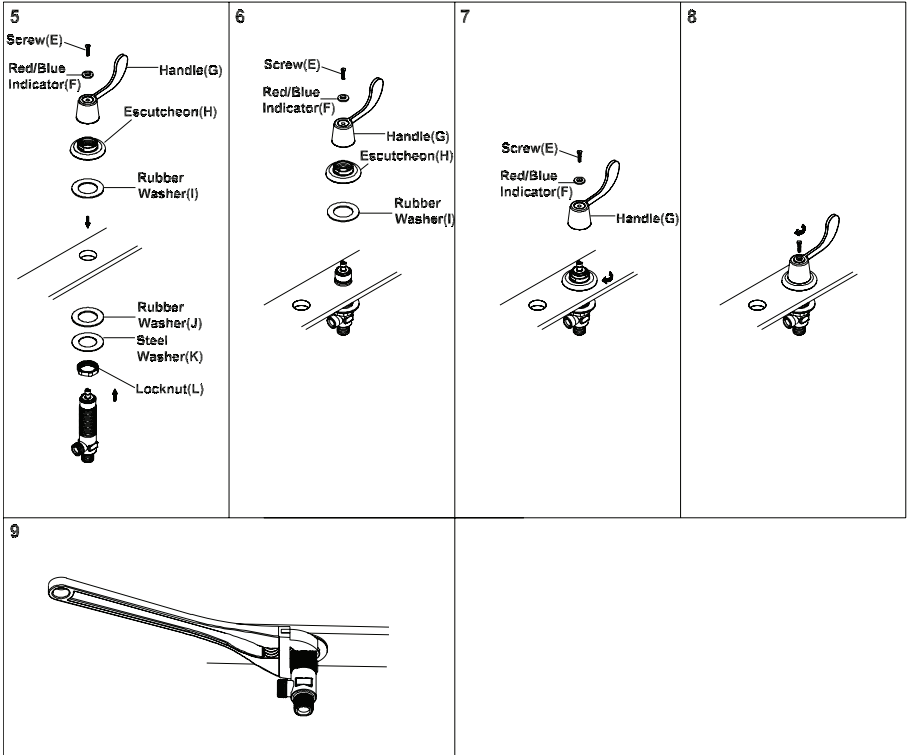

Pop-Up Drain Installation

10. Remove the 'Y' connector (N). Make sure the washer (M) is in the 'Y' connector (N).
11. Connect the 'Y' connector (N) to the spout shank. Place necessary Teflon tape at the end of the spout if necessary. Do not overtighten.
12. Place necessary Teflon tape at the outlet of the valve body. Connect the supply hose (O) to the outlet of the cold side valve body. Tighten with adjustable wrench. Do not overtighten.
13. Place necessary Teflon tape at the outlet of the valve body. Connect the supply hose (O) to the outlet of the hot side valve body.
14. Place necessary Teflon tape at the end of the 'Y' connector. Connect the other ends of the supply hoses to the 'Y' connector (N). Tighten with adjustable wrench. Do not overtighten.
15. Ensure the both side of the supply hoses are securely connected.

10

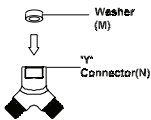

11

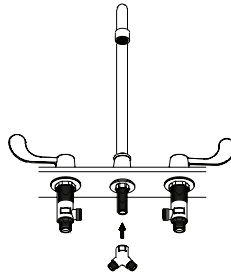

12

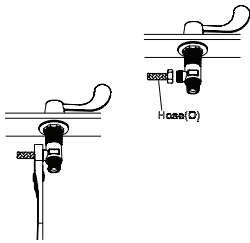

13

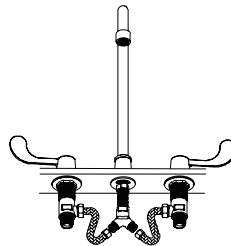

14

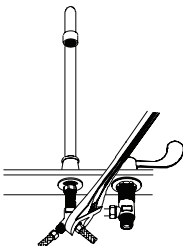

15

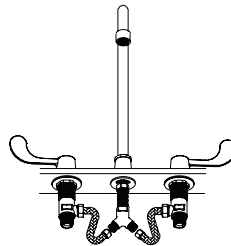

Main Supply Connection

16. Connect the Valves to inlet supply lines (P). Connect the supply stops (Q) to the inlet supply lines (P) (left is hot water supply and right is cold water supply). Make sure inlet supply lines (P) are securely tighten. Do not over tighten. Turn on water. Check for any leaks. Make sure all the connections are secure.
17. Turn on water. Remove aerator(R) with the help of tool(S)
18. Turn the handles on.
19. Flush and allow water to run at full flow for at least one minute.
20. Turn the handles off.
21. Replace aerator (S) with the help of tool(S).

16

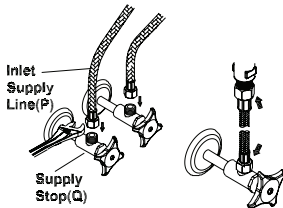

17

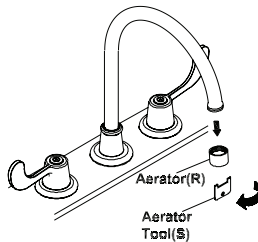

18

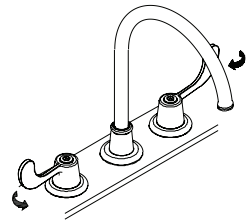

19

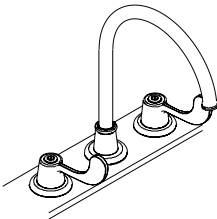

20

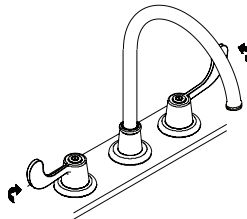

21

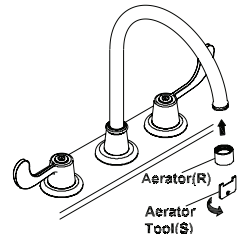

For more care information or trouble shooting inquiries about your Pioneer product, please see the contact information on the back page.



ENGINEERING EXCELLENCE

3325 S. Garfield Ave | City of Commerce, CA 90040
Telephone: (800) 338-9468 | (323) 888-8873 | Fax: (323) 888-9515
Hours: M - F, 7:30am to 5:00pm PST