



# ENGINEERING EXCELLENCE

Legacy Series #2LG120

PARTS BREAKDOWN SHEET

### DESCRIPTION

- Two Handle Kitchen Faucet
- ADA Wrist Blade Handles
- Spout Swivel 360°
- 9-11/16" Reach, 5-1/4" From Deck to Aerator
- Ceramic Disc Cartridges
- 3-Hole 8" Installation

### FINISHES

- PC PVD Polished Chrome



#2LG120 SHOWN \* ADA 

### STANDARDS APPLICABLE

- ASME A112.18.1
- ANSI A117.1
- ANSI / NSF 61, SECTION 9
- CUPC / IAPMO LISTED / ADA COMPLIANT
- CONTAINS NO MORE THAN 0.25% WEIGHTED AVERAGE LEAD CONTENT

### FLOW

- Aerator Limited to 1.5 GPM

Model #: \_\_\_\_\_

Specific Features: \_\_\_\_\_

Project Name: \_\_\_\_\_

Submitted For: \_\_\_\_\_

| Model   | Description               | Finishes                    |                                  |
|---------|---------------------------|-----------------------------|----------------------------------|
| #2LG120 | Two Handle Kitchen Faucet | <input type="checkbox"/> PC | <input type="checkbox"/> Other__ |



ENGINEERING EXCELLENCE

Pioneer: 1-800-338-9468  
 Commerce, CA 90040  
 www.pioneerind.com  
 Pioneer Industries, Inc. © 2013

DMPB2LG120/REV. 12 2012

Page 1 of 2

| ITEM# | DESCRIPTION                                    |
|-------|--|
| A     | X-1900003C,H ADA Wrist Blade Handle- Cold, Hot |
| B     | X-4900007 Bonnet Nut                           |
| C     | X-4200014 Deck Plate                           |
| D     | X-3900002C Ceramic Stem - Cold                 |
| E     | X-3900002H Ceramic Stem - Hot                  |
| F     | X-4200006 Base Plate                           |
| G     | X-4900008 Mounting Kit                         |
| H     | X-4900004 Supply Nut                           |
| I     | X-4200058 Cap                                  |
| J     | X-4200011 Retainer Nut & Washer                |
| K     | X-2200002 Legacy Spout                         |
| L     | X-4200012 Spout O-Ring                         |
| M     | X-4200013 Spout Gasket                         |
| 1     | X-4900010 ADA Wrist Blade Handle Screw         |
| 2     | X-4900011C,H Handle Index-Cold & Hot           |
| 3     | X-4900081 1.5 GPM Aerator                      |

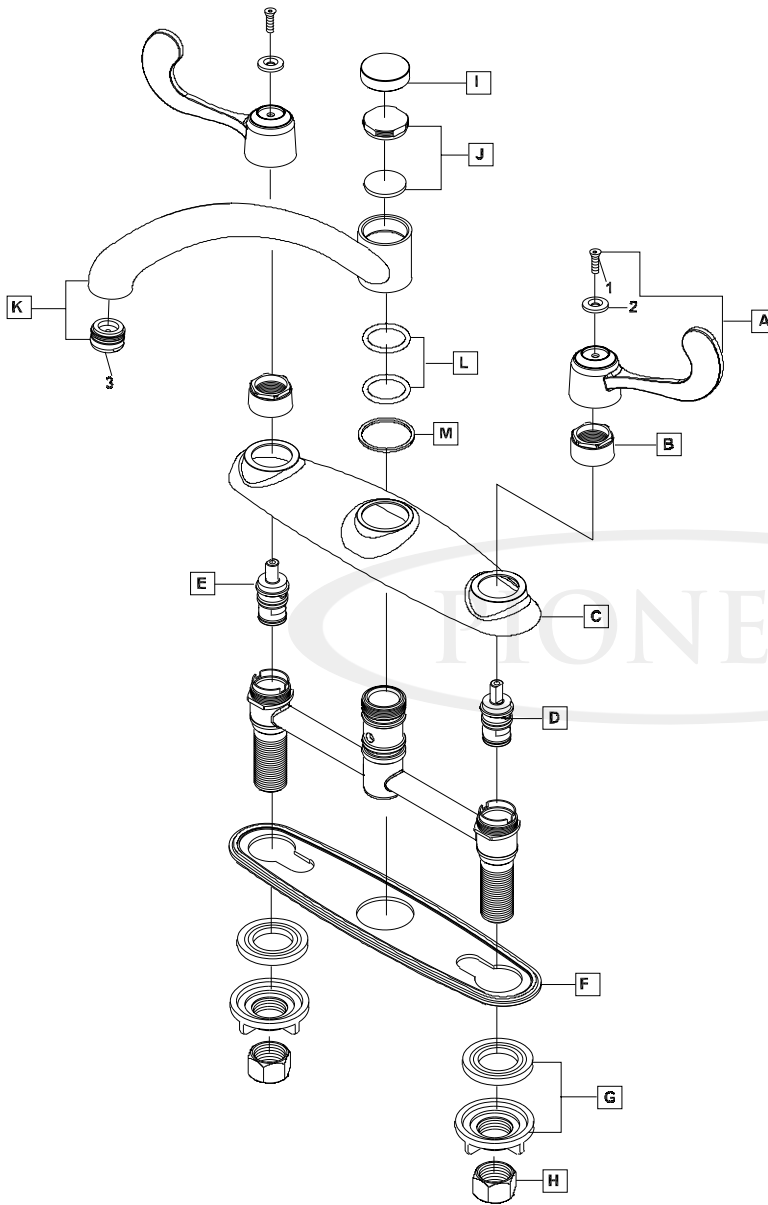

Product Diagram



ENGINEERING EXCELLENCE

Pioneer: 1-800-338-9468  
 Commerce, CA 90040  
 www.pioneerind.com  
 Pioneer Industries, Inc. © 2013