



# ENGINEERING EXCELLENCE

## Caesar Collection #2CS330

## PARTS BREAKDOWN SHEET

### DESCRIPTION

- Single Handle Kitchen Faucet
- Metal Lever Handle
- Spout Swivel 360°
- 9" Reach, 7-7/8" from Deck to Aerator
- Ceramic Disc Cartridge with Temperature Limit Stop
- 2-Hole 4" to 23" Installation

### FINISHES

- PC PVD Polished Chrome
- BN PVD Brushed Nickel
- SS PVD Stainless Steel
- PN PVD Polished Nickel
- GR PVD Golden Rose



#2CS330 SHOWN \* ADA 

### STANDARDS APPLICABLE

- ASME A112.18.1
- ANSI A117.1
- ANSI / NSF 61, SECTION 9
- CUPC / IAPMO LISTED / ADA COMPLIANT
- CONTAINS NO MORE THAN 0.25% WEIGHTED AVERAGE LEAD CONTENT

### FLOW

- Aerator Limited to 1.5 GPM

Model #: \_\_\_\_\_

Specific Features: \_\_\_\_\_

Project Name: \_\_\_\_\_

Submitted For: \_\_\_\_\_

Model	Description	Finishes	
#2CS330	Single Handle Kitchen Faucet	<input type="checkbox"/> PC	<input type="checkbox"/> Other__



ENGINEERING EXCELLENCE

Pioneer: 1-800-338-9468  
 Commerce, CA 90040  
 www.pioneerind.com  
 Pioneer Industries, Inc. © 2013

DMPB2CS330/REV. 12 2012

Page 1 of 2

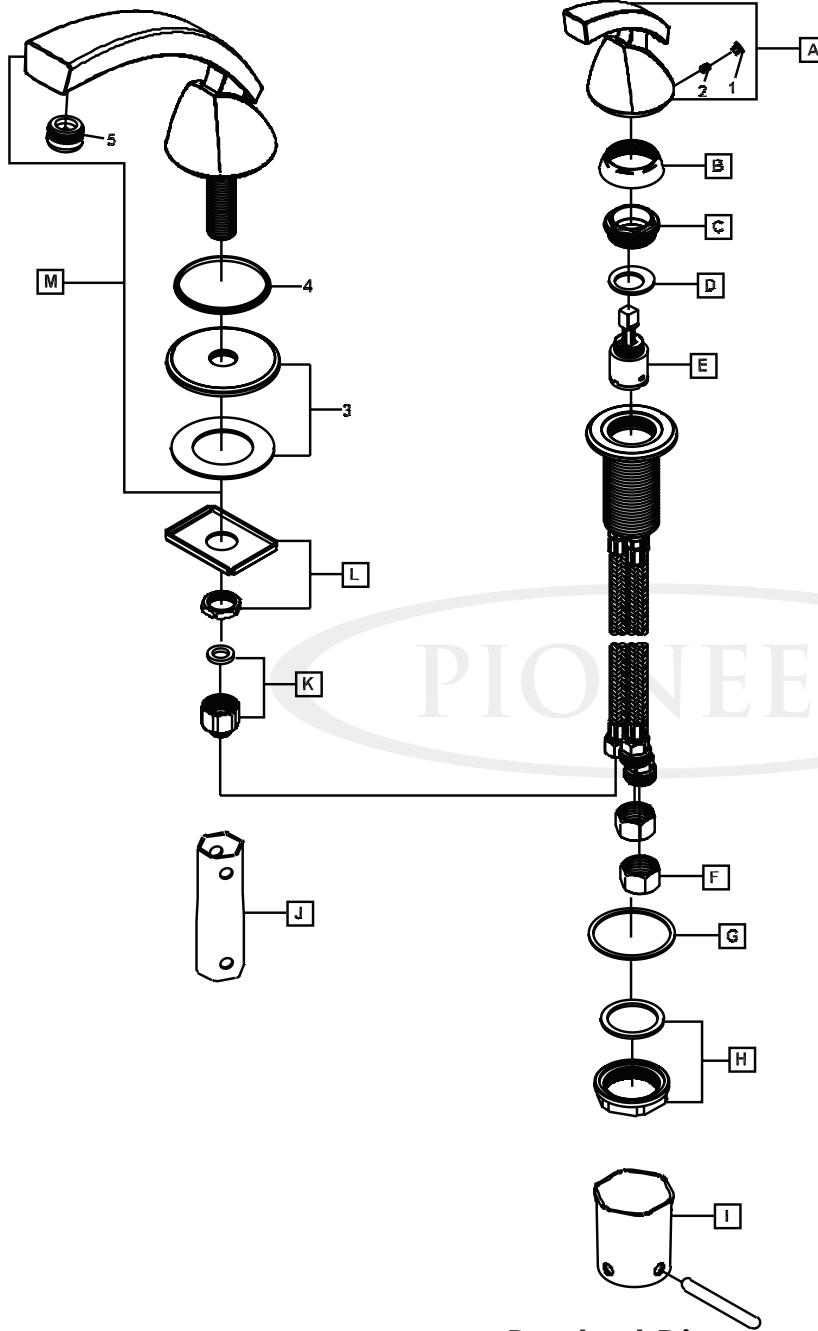

ITEM#	DESCRIPTION
A	X-1900016* Metal Handle
B	X-4900058* Retainer Sleeve
C	X-4200135 Retainer Nut
D	X-4200136 Washer
E	X-3200007 Ceramic Disc Cartridge
F	X-4900004 Supply Nut
G	X-4200137 Gasket
H	X-5200016 Mounting Kit
I	X-5200005 Mounting Tool
J	X-5900006 Mounting Tool
K	X-4200138 Spout Adapter
L	X-5200003 Mounting Kit
M	X-2200026* Caesar Spout
1	X-4900044* Hole Cover
2	X-4400024 3/32" Allen Screw
3	X-4200139* Spout Flange
4	X-4200140 Gasket
5	X-4900081* 1.5 GPM Flow Rate Aerator

\* Note: Please specify finish/color when ordering.

Product Diagram



ENGINEERING EXCELLENCE

Pioneer: 1-800-338-9468  
 Commerce, CA 90040  
 www.pioneerind.com  
 Pioneer Industries, Inc. © 2013