



## ENGINEERING EXCELLENCE

Americana Series #2AM101

PARTS BREAKDOWN SHEET

### DESCRIPTION

- Two Handle Kitchen Faucet
- Metal Lever Handles
- Spout Swivel 360 °
- 8-11/16" Reach, 7-7/8" from Deck to Aerator
- Ceramic Disc Cartridges
- 4-Hole 8" Installation
- Side Spray Assembly

### FINISHES

- PC PVD Polished Chrome
- BN PVD Brushed Nickel
- SS PVD Stainless Steel
- PN PVD Polished Nickel
- PB PVD Polished Brass
- GR PVD Golden Rose
- ORB Oil Rubbed Bronze
- TB PVD Tuscany Bronze



#2AM101 SHOWN \* ADA 

### STANDARDS APPLICABLE

- ASME A112.18.1
- ANSI A117.1
- ANSI / NSF 61, SECTION 9
- CUPC / IAPMO LISTED / ADA COMPLIANT
- CONTAINS NO MORE THAN 0.25% WEIGHTED AVERAGE LEAD CONTENT

### FLOW

- Aerator Limited to 1.5 GPM

Model #: \_\_\_\_\_

Specific Features: \_\_\_\_\_

Project Name: \_\_\_\_\_

Submitted For: \_\_\_\_\_

| Model   | Description               | Finishes  |
|---------|---------------------------|---|
| #2AM101 | Two Handle Kitchen Faucet | <input type="checkbox"/> PC <input type="checkbox"/> Other ____ |



ENGINEERING EXCELLENCE

Pioneer:1-800-338-9468  
 Commerce, CA 90040  
 www.pioneerind.com  
 Pioneer Industries, Inc. © 2013

DMPB2AM101/REV. 12 2012  
 Page 1 of 2

|   | ITEM#         | DESCRIPTION                |
|---|---------------|----------------------------|
| A | X-1900007C,H* | Lever Handles-Cold,Hot     |
| B | X-4900037     | Bonnet Nut                 |
| C | X-4900038     | Gasket                     |
| D | X-3900004C,H  | Ceramic Cartridge-Cold,Hot |
| E | X-4200060*    | Deck Plate                 |
| F | X-4200061     | Base Gasket                |
| G | X-4900008     | Mounting Kit               |
| H | X-4900004     | Supply Nut                 |
| I | X-2200011*    | Americana Spout            |
| J | X-4200016     | Diverter Piston            |
| K | X-4200059*    | Side Spray Assembly        |
| 1 | X-4900042C,H* | Button-Cold, Hot           |
| 2 | X-4900035     | Handle Screw               |
| 3 | X-4900091*    | 1.5 GPM Aerator            |
| 4 | X-4900012     | Spout O-Rings              |

\* Note- Please specify finish/color code while ordering.

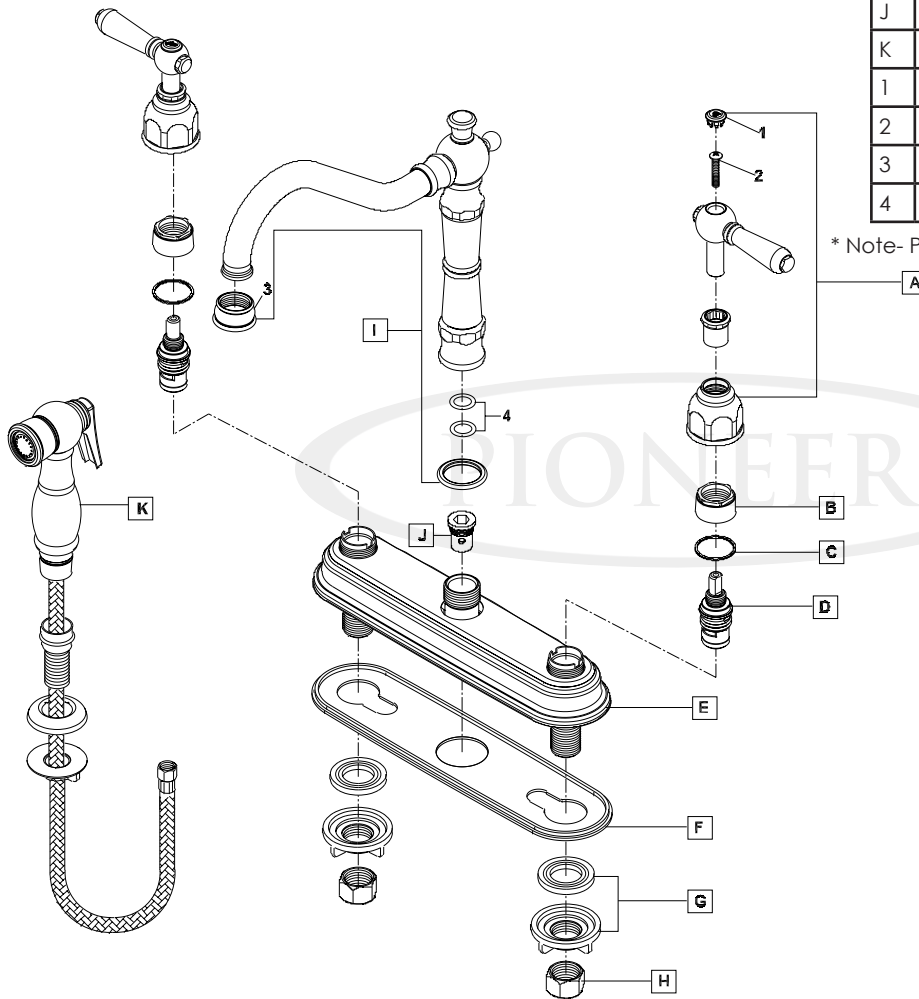

Product Diagram



ENGINEERING EXCELLENCE

Pioneer:1-800-338-9468  
 Commerce, CA 90040  
 www.pioneerind.com  
 Pioneer Industries, Inc. © 2013