

# INSTALLATION



**Model Number:**  
KF-GNPD

## TOOLS:



Phillips Screwdriver



Pliers



Plumber's Putty



Adjustable Wrench



Pipe Tape



Hex Wrench

## CLEANING:

To maintain and protect the fine luster of all products, clean with a soft, damp cloth only. DO NOT USE detergents or cleansers as they may harm the protective finish.

## INSTALLATION STEPS:

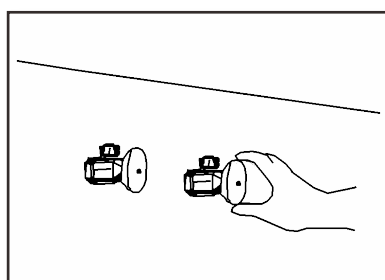

1. Shut off water supply. Remove old faucet. Clean sink surface in preparation for new faucet

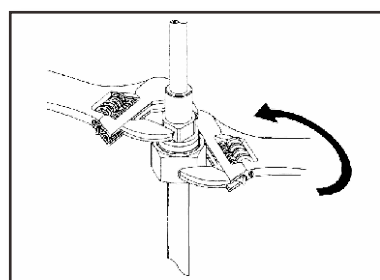

4. Attach water supply hose to the faucet. Tighten end of shank with wrench and slip hose onto inlet port.

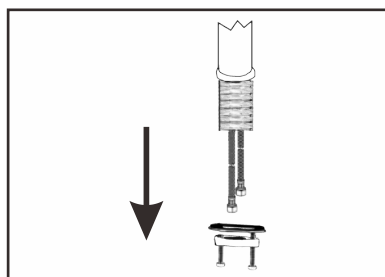

2. Remove rubber washer, metal washer and lock nut from brass shank.

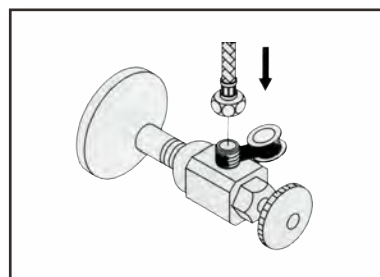

5. Apply pipe tape onto threads of the water supply.

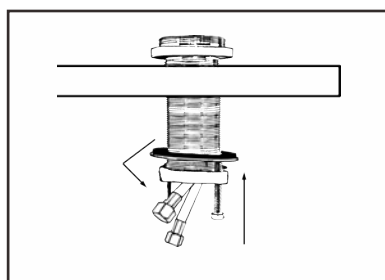

3. Position new faucet. Attach rubber seal, metal washer, and lock nut on mounting body. Tighten the two screws on lock nut.

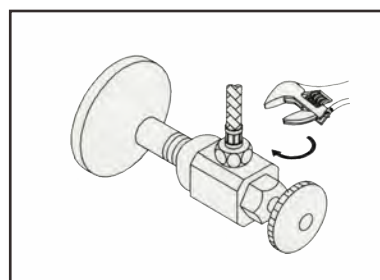

6. Tighten the hose onto water supply.

**Maintenance:** Your new faucet is designed for years of trouble-free performance. Keep it looking new by cleaning it periodically with a soft cloth. Avoid abrasive cleaners, steel wool and harsh chemicals as these will dull the finish and void your warranty.

Please call our Customer Service toll free line at 1-888-796-0605 for additional assistance or service