

Installation manual for hand shower :

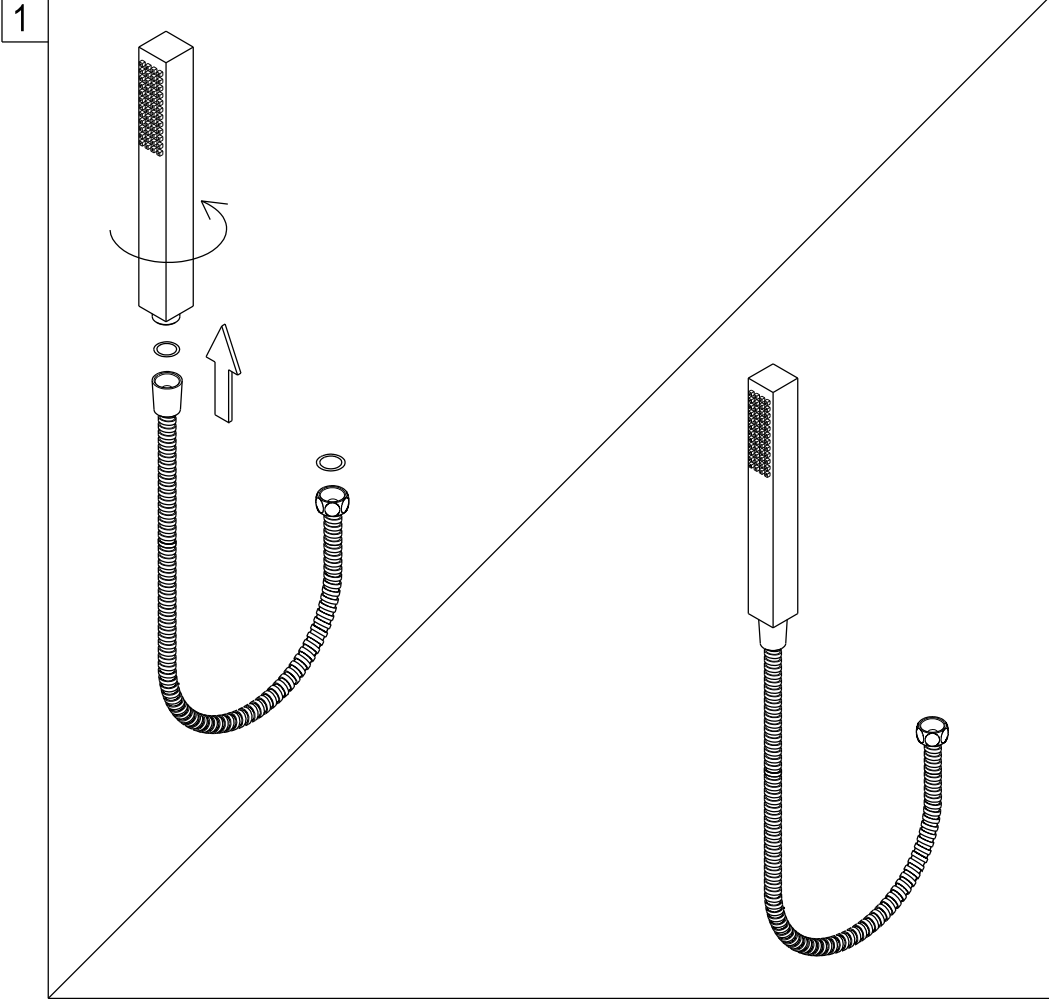

1. Put a washer to the cone shape hose nut and hand tightens the hand shower clockwise.
2. Turn on the water and check for leaks, if the hand shower leaks at the connection to the hose, hand tighten the connection some more.

**KINGSTON BRASS**  
THE TRADITION OF FINE BRASS

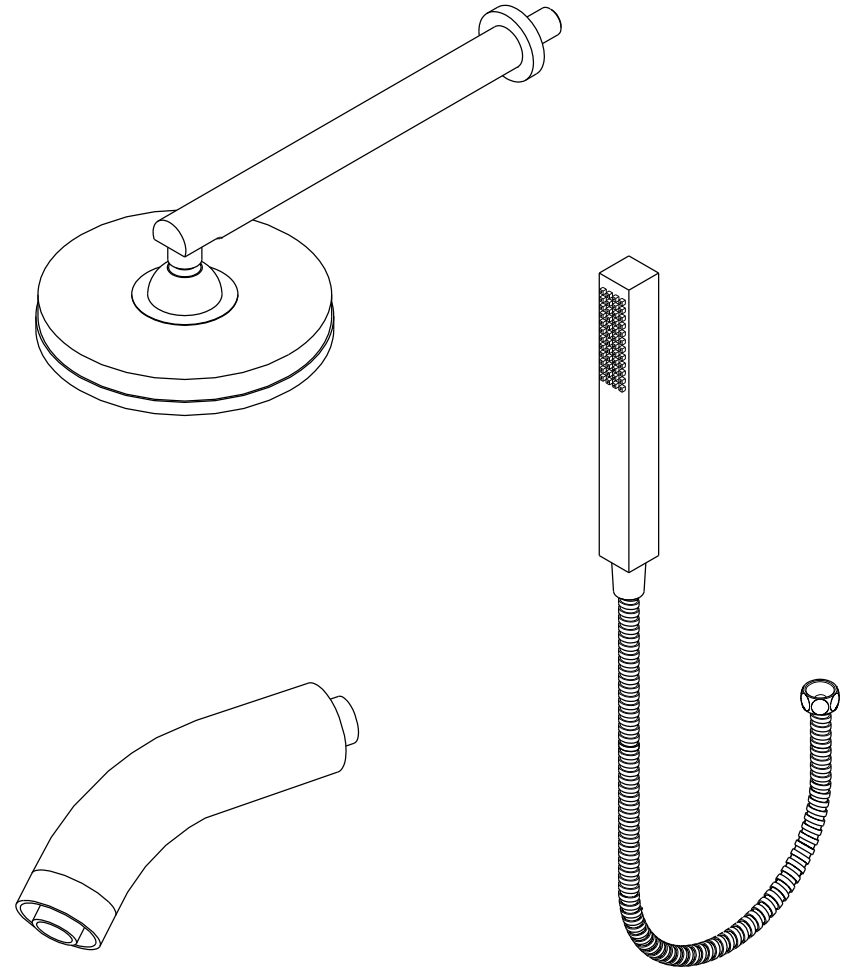

www.kingstonbrass.com  
TOLL-FREE CUSTOMER SERVICE: 1-877-2-KBRASS  
TECHNICAL SUPPORT E-mail: [service@kingstonbrass.com](mailto:service@kingstonbrass.com)  
12775 Reservoir Street, Chino, CA91710

# KINGSTON BRASS

THE TRADITION OF FINE BRASS

## INSTALLATION INSTRUCTIONS

For Use With KB's Hand Shower Sets, Shower Head Sets and Deck Mount Sprayer

### Before installation:

Hold the existing shower arm up and down to ensure the plumbing behind the wall is rigid to hold the weight of the new shower unit - about 3-4 lbs when filled with water.

### Installation manual for Shower Arm:

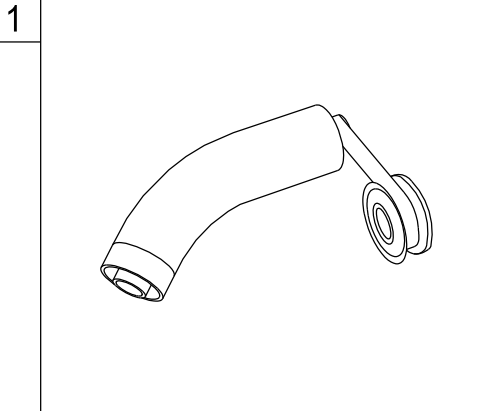

1. Wrap threads on one end of shower rod male nipple with 4 to 6 wraps of teflon's tape.

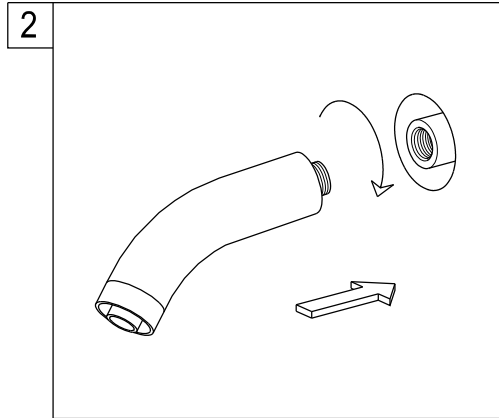

2. Thread the male nipple into female nipple (in wall), tighten with pipe wrench.

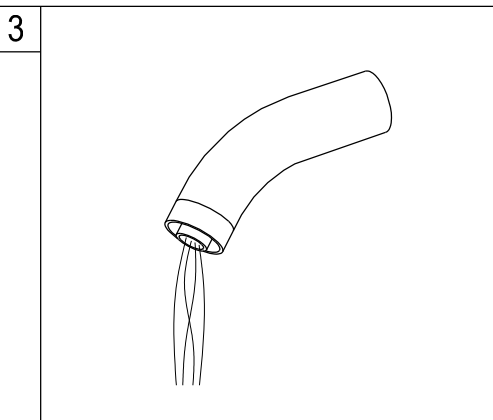

3. Turn the water on and check for leaks, any leaks will require minor tightening or adjustment.

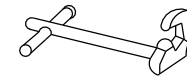

Basin Wrench



Adjustable Wrench



Teflon's Tape

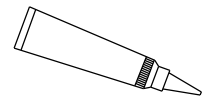

Silicone Sealant

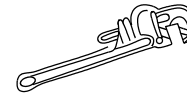

Pipe Wrench

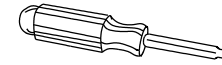

Screwdriver



Flexible Water Supply Line



Plumber's Putty

### Installation manual for shower arm & shower head:

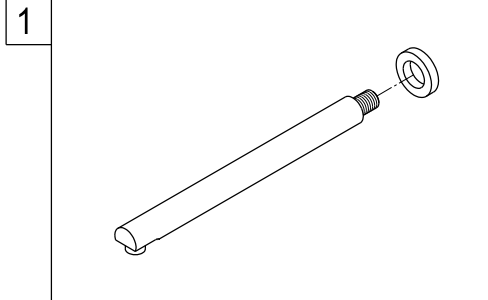

1. Place the flange into the shower rod.

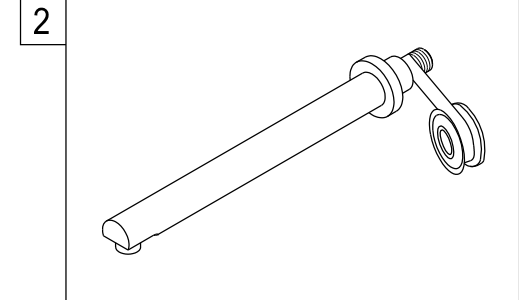

2. Wrap threads on one end of shower rod male nipple with 4 to 6 wraps of teflon's tape.

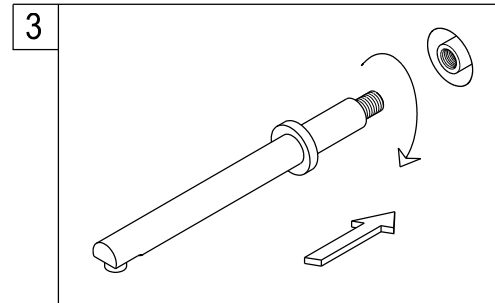

3. Thread the male nipple into female nipple (in wall), tighten with pipe wrench.

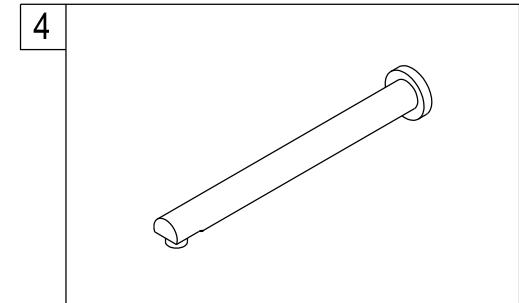

4. Turn the water on and check for leaks, any leaks will require minor tightening or adjustment.

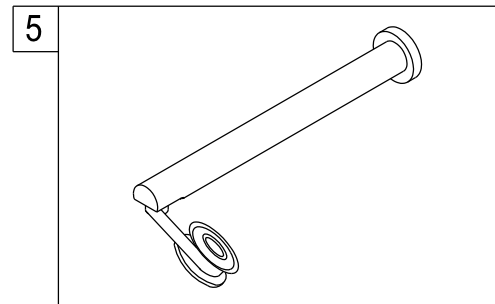

5. Wrap teflon tape around all the threads on shower rod and hand tighten the shower head clockwise.

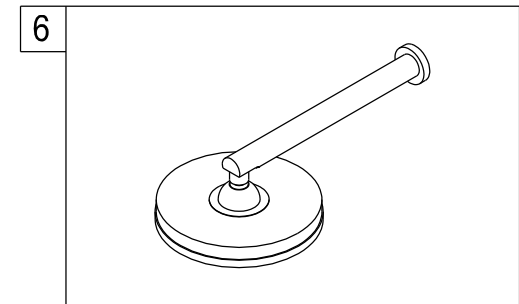

6. Turn the water on and check for leaks, any leaks will require minor tightening or adjustment. If the shower head leaks at the connection to the thread shower arm, tighten the connection some more by using a wrench.