

NOTES:

1  APPLY PERMANENT THREAD LOCKER (LOCTITE 680)

2. BAG ITEMS 1 AND 7. ASSEMBLE ALL REMAINING ITEMS.

BILL OF MATERIAL (CURRENT LEVEL)

ITEM	PT/ASSY	DESCRIPTION	TYPE	QTY.
1	1-206	HARDWARE PACK	ASSEMBLY	2
2	7-692	TOWEL BAR AND INSERT ASSY	ASSEMBLY	1
3	40412	TOWEL BAR POST LEFT	PART	1
4	40413	TOWEL BAR POST RIGHT	PART	1
5	91527	O-RING 3MM ID X 1MM WIDTH BUNA-N, SHORE A 70 (MMC# 9262K441)	PART	4
6	92001	8 - 32 X 3/16 FLAT POINT SET SCREW	PART	2
7	92422	HEX KEY, 1/8" ALLOY STEEL (MMC# 7122A18)	PART	1
8	92437	MOUNTING BRACKET	PART	2
9	92454	THREADED STUD - LONG	PART	4
10	92495	SCRW, 1/4-28 x 3/8" CUP POINT SET SS (MMC # 92311A558)	PART	2

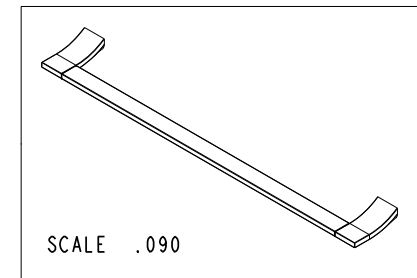
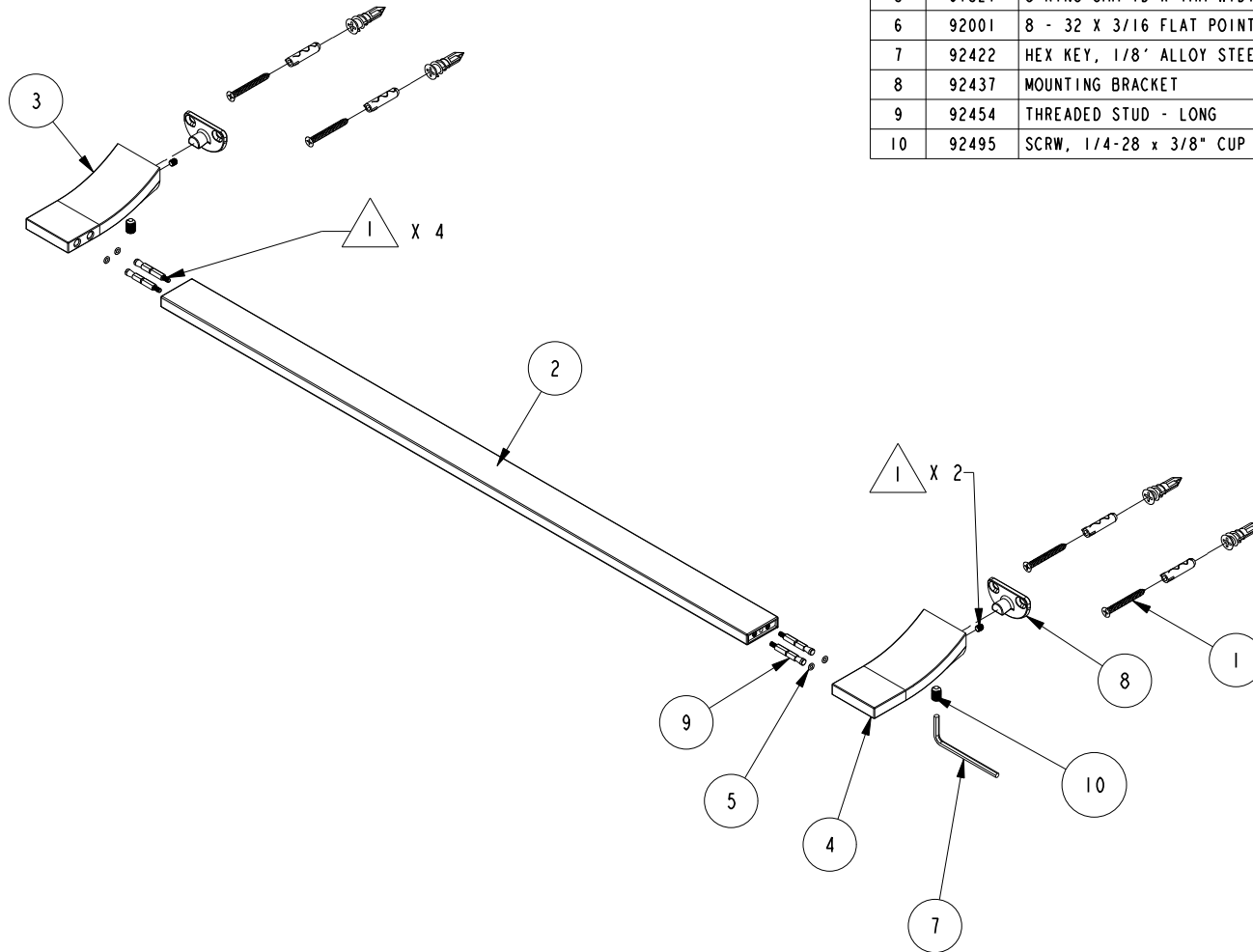

COPYRIGHT 2005 GINGER. THESE DRAWINGS AND THE DESIGNS DEPICTED HEREIN ARE THE PROPRIETARY PROPERTY OF GINGER. ANY USE OR REPRODUCTION IS SUBJECT TO THE EXPRESS APPROVAL OF GINGER. UNAUTHORIZED USE IS STRICTLY PROHIBITED. ALL RIGHTS RESERVED.

GINGER

2001 E. CARNEGIE AVE.
SANTA ANNA CA 92705
(949) 417-5207

24" TOWEL BAR

ASSY. NO. 4703

SCALE .250

REF. -

SHEET 1 OF 2

C	EN-1718	04/01/11
B	EN-1701	02/17/11
A	EN-1683	01/06/11
-	EN-1294	11/09/10
REV	REV DESC	DATE

SPECIFICATION DWG

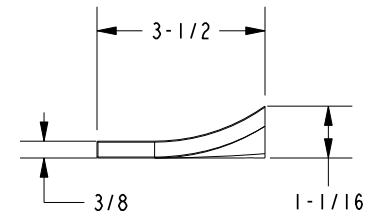
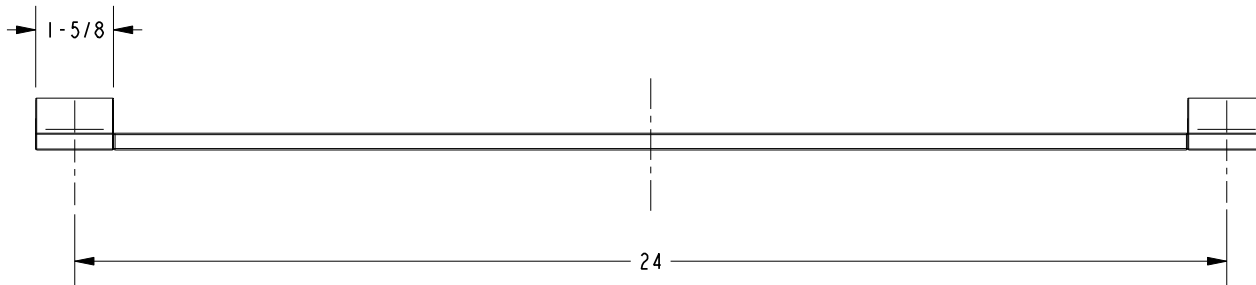
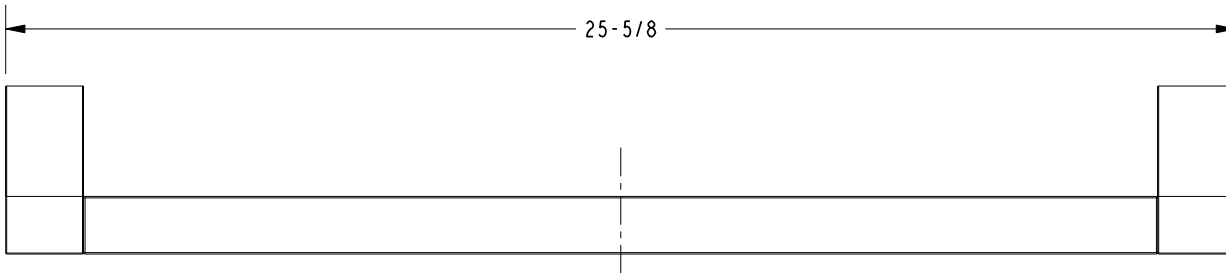

DIMENSIONS ARE IN INCHES AND AN APPROXIMATION OF A TYPICAL INSTALLATION

COPYRIGHT 2005 GINGER. THESE DRAWINGS AND THE DESIGNS DEPICTED HEREIN ARE THE PROPRIETARY PROPERTY OF GINGER. ANY USE OR REPRODUCTION IS SUBJECT TO THE EXPRESS APPROVAL OF GINGER. UNAUTHORIZED USE IS STRICTLY PROHIBITED. ALL RIGHTS RESERVED.

GINGER		2001 E. CARNEGIE AVE. SANTA ANNA CA 92705 (949) 417-5207	
DWG NO.	4703	REV	C
SCALE	.375	REF.	-
SHEET		2	OF 2