

4

3

2

NOTES:

- ① 1. FIT / FORM / FUNCTION SHALL FOLLOW PS-E.008.
- ② ITEM 1 RECEIVED FROM SUPPLIER ALREADY IN POLYBAG.
(TOTAL OF 12 RINGS). PLACE ITEM 1 IN A H-190 CARTON.
- 3. AFFIX PRODUCT LABEL ON THE CARTON ACCORDINGLY.

BILL OF MATERIAL (CURRENT LEVEL)

ITEM	PT/ASSY	DESCRIPTION	TYPE	QTY.
1	1139SR.12PK	SHOWER CURTAIN RING	ASSEMBLY	1

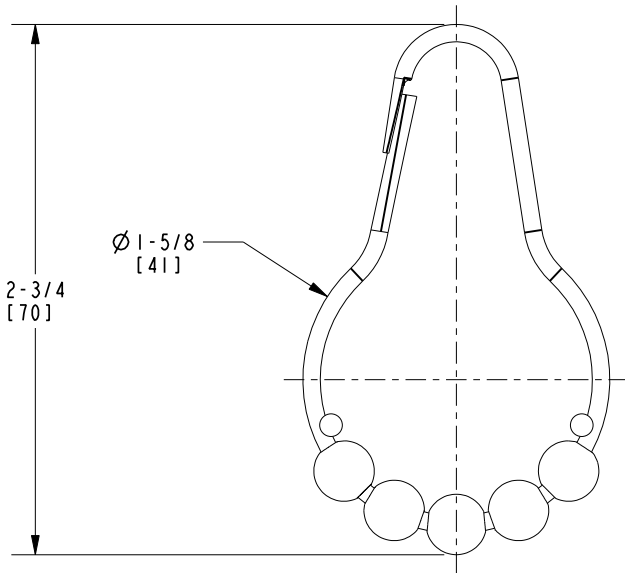
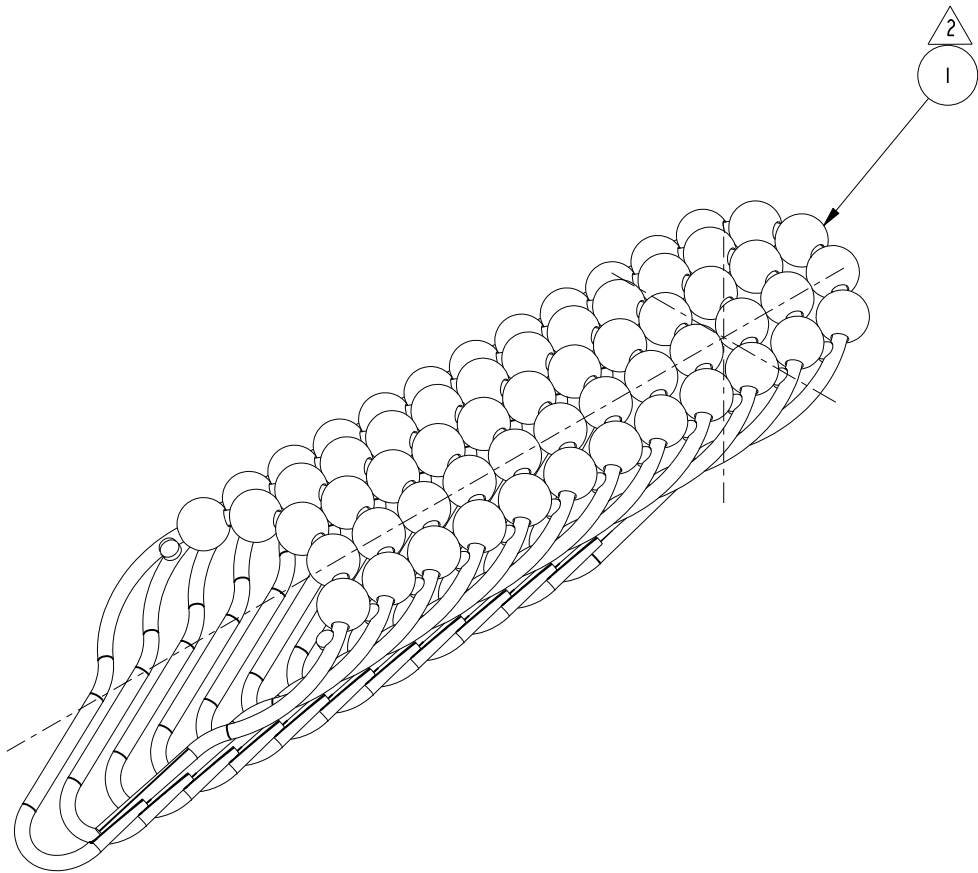

COPYRIGHT 2005 BRASSTECH, INC. THESE DRAWINGS AND THE DESIGNS DEPICTED HEREIN ARE THE PROPRIETARY PROPERTY OF BRASSTECH. ANY USE OR REPRODUCTION IS SUBJECT TO THE EXPRESS APPROVAL OF BRASSTECH. UNAUTHORIZED USE IS STRICTLY PROHIBITED. ALL RIGHTS RESERVED.

TESTING	-	-	-
ASSEMBLY	-	-	-
PLATING	-		
POLISHING	-	NEXT ASSY	USED ON
MACHINING	-	APPLICATION	
TOOLING FIXTURE #		REMOVE ALL BURRS AND SHARP EDGES	

UNITS ARE: INCHES [MM]		
TOLERANCES ARE:		
FRACTIONS	DECIMALS	ANGLES
± 1/16"	.X ± .1 [2.5]	± 1°
	.XX ± .06 [1.5]	
(X.XXX) DENOTES CRITICAL DIMS. ALL THREADS ARE CRITICAL		
DRAWN	NMS	06/18/18
CHECKED	N. SANTOS	06/18/18
APPROVED	N. SANTOS	06/18/18

BRASSTECH 2001 CARNEGIE AVE. SANTA ANA, CA 92705 (949) 417-5207
INCORPORATED

SHOWER CURTAIN RINGS-12 PK

DWG NO. 1139SR REV -

SCALE .880 REF. - SHEET | OF |

-	-	EN-3606	06/18/18	NS
ZONE	REV	DESCRIPTION	DATE	APPROVED

4

3

2

1