

# AMERICH®

## ANDRINA 7236

FREESTANDING



### DIMENSIONS

72 x 36 x 24 deep (1829 x 914 x 610 mm)  
Gallon to Overflow = 85 (Liters = 322)

### MATERIAL

Polymer Composite

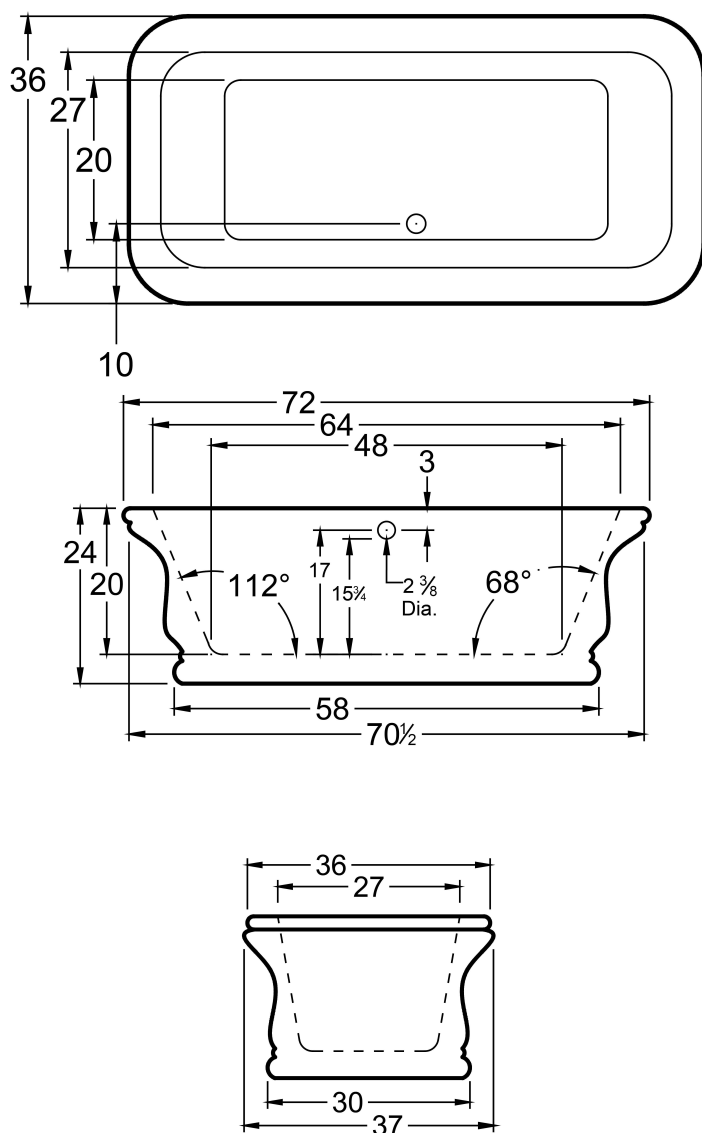

### TUB FLOOR

Textured

### UNDERMOUNT: NO

This tub is not designed for undermount installation.

### APPROVALS & COMPLIANCE



Americh products meet or exceed the following standards:

- Underwriters Laboratories (UL)
- Underwriters Laboratories - Canada (cUL)
- ANSI Z124.1 • ANSI A112-19.7
- ANSI A112.19.8

Contact Americh for additional approvals.

## LEGEND



Remote Blower Connection



ON/OFF Control

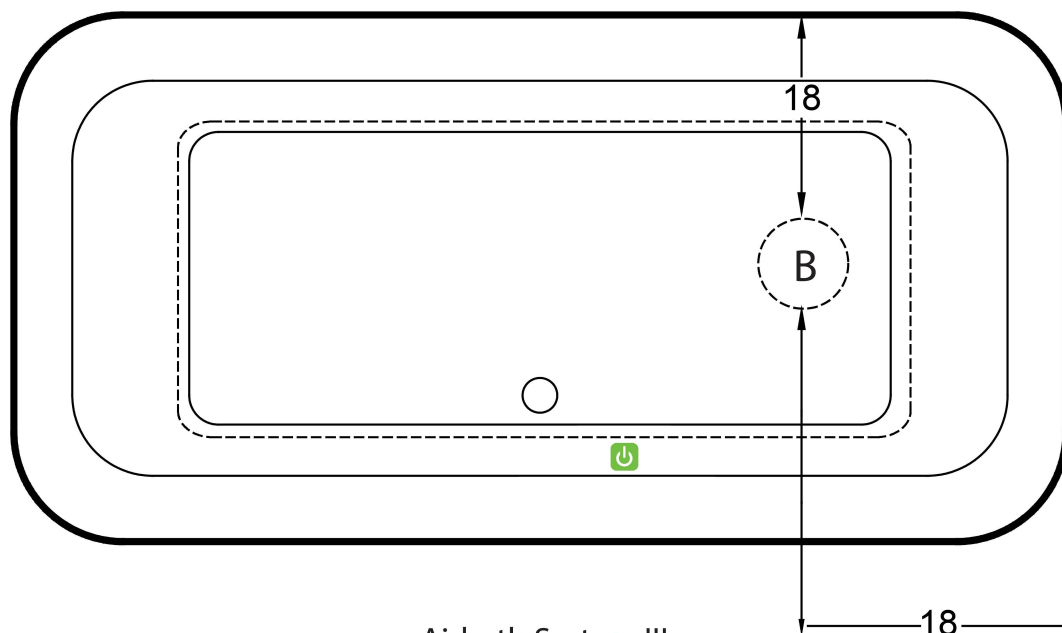

Airbath System III

Blower must be remotely located

(Diagram is required for custom blower connection locations)

## STANDARD EQUIPMENT

- Integral Waste & Overflow
- Lift Bag Included

## OPTIONAL ACCESSORIES

- Color Upcharge
- Custom Color Upcharge
- Drop-in Drain Kit
- Pillows: 12" \*
- Trim Plate for Linear Overflow

## INSTALLATION TIPS

- Install according to Owner's Manual and local codes.
- Always consult your local plumber for recommendations as installations will vary.
- The bath must be secured to the floor by applying a bead of silicone around the base.
- Installation must be carried out according to the manufacturer instructions.
- Hot water supply should be 65-75% of tub capacity or greater.
- Tubs with Airstystem may require piping thru the subfloor. Bathrooms on concrete slab may require modification to the tub or installation on a platform to run air piping to the blower in a remote location. (Remote Blower Location Required)

## ELECTRICAL REQUIREMENTS

Americh recommends one 20 amp ground fault circuit interrupter (GFCI) for each power supply provided with the bathtub.