

NEWPORT BATH

Features

Solid brass construction  
1/2" In-wall diverter valve, 3 function with pause. 1 inlet, 3 outlets.  
Requires Newport Brass Handle Trim (many options available, sold-separately)  
No Finish

1/2" IN-WALL DIVERTER VALVE

1-703



Codes / Standards Compliance

Meets or exceeds the following at date of manufacture:

ASME A112.18.1/CSA B125.1-18  
IAPMO/cUPC  
IPC  
California Energy Commission  
All applicable US Federal and State material regulations

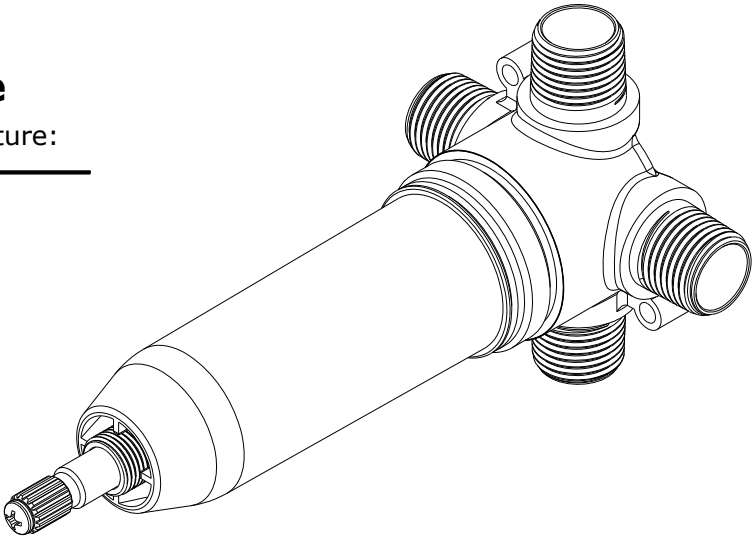

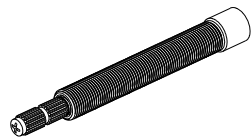
ACCESSORY OPTIONAL	
System Element	Stem Extension
Description	Stem Extension Kit
Part Number	1-384
Image	

# 1-703

## PRODUCT DIMENSIONS *(Units are in inches)*

Product Dimensions are provided for reference only. For specific product installation guidelines, please reference the Installation Instructions of the product being installed.

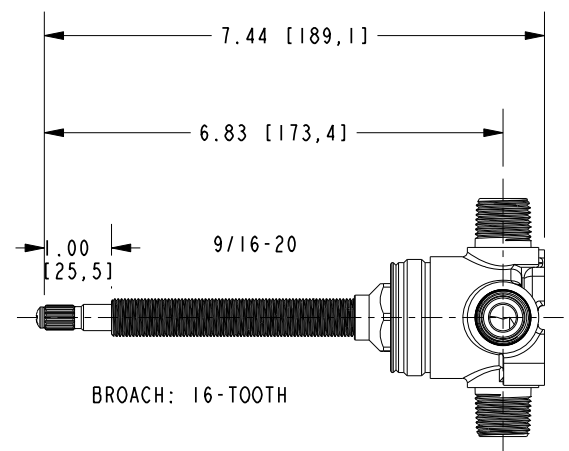
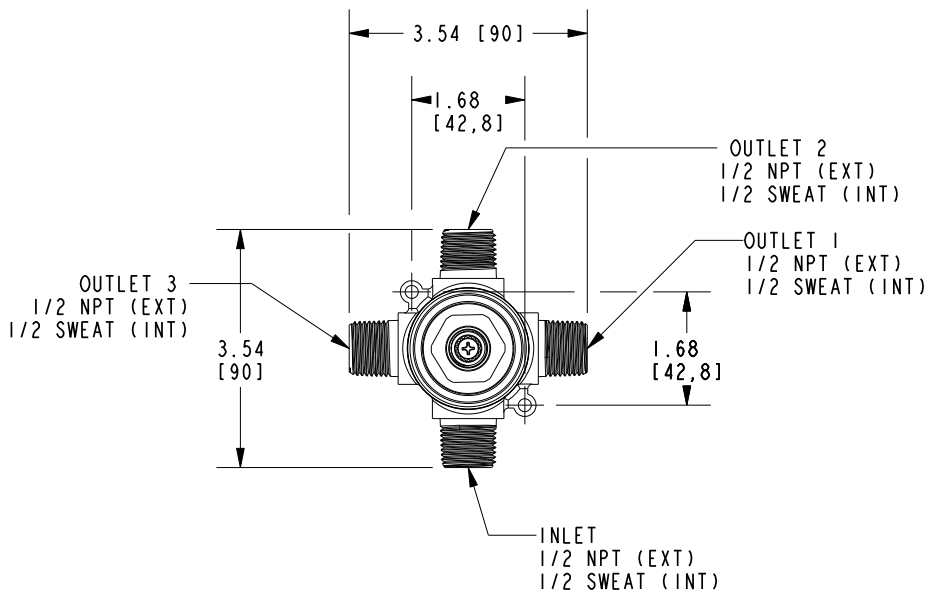

1/2" IN-WALL DIVERTER VALVE

1-703

Page 2 of 2

EN- 5038

REVE

**NEWPORT BRASS**  
Flawless Beauty. From Faucet to Finish.

t: 949.417.5207 | [www.newportbrass.com](http://www.newportbrass.com)  
©2025 NewportBrass