

PORTASCIUGAMANO SIRIO

SIRIO TOWEL BAR / PORTE-SERVIETTE SIRIO

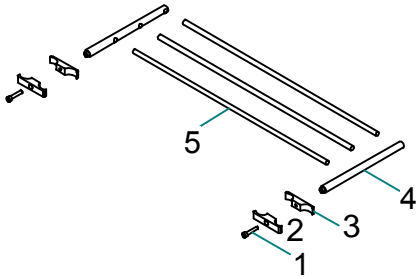

- 1) VITE DI FISSAGGIO / fixing screw / vis de fixation
- 2) STAFFA POSTERIORE / back bracket / attache arrièr
- 3) STAFFA ANTERIORE / frontal bracket / attache frontal
- 4) PERNO / hinge / pivot
- 5) ASTA PORTASCIUGAMANO / towel bar / porte-serviette

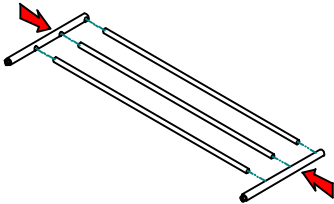

- A) INTRODURRE LE TRE BARRE (PUNTO 5) NEI DUE PERNI (PUNTO 4) ESERCITANDO UNA LIEVE PRESSIONE PER BEN INCASTRARLE.
- A) Set the three bars (point 5) in the two hinges (point 4) with a light press.
- A) Introduire les trois barres (point 5) dans les pivots (point 4) en exerçant une petite pression.

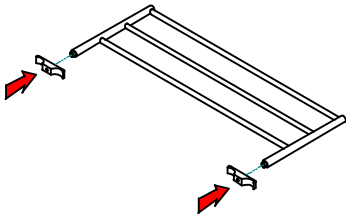

- B) AVVITARE LE DUE STAFFE ANTERIORI (PUNTO 3) AI PERNI.
- B) Screw the frontal brackets (point 3) to the hinges.
- B) Visser les attaches frontaux (point 3) aux pivots.

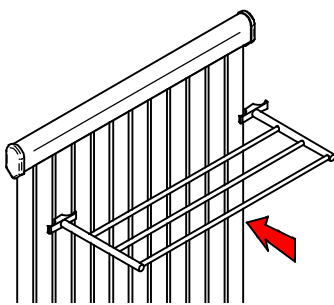

- C) DECIDERE DOVE POSIZIONARE IL PORTASCIUGAMANO E APPOGGIARLO ALLO SCALDASALVIETTE FACENDO ATTENZIONE A NON STRISCIARE LA SUPERFICIE.
- C) Decide where to install the towel bar and lay it on the heater paying attention not to scratch the surface.
- C) Decider où installer le porte-serviette et poser le sur le radiateur en prêtant attention à ne pas érafler la surface.

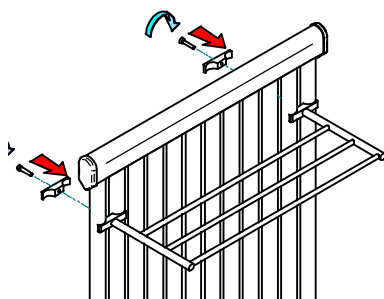

- D) FISSARE LE STAFFE POSTERIORI (PUNTO 2) A QUELLE ANTERIORI CON LA VITE DI FISSAGGIO (PUNTO 1) IN MODO DA AGGANCIARLE AI TUBI.
- D) Fix the back brackets (point 2) to the frontal brackets (point 3) with the fixing screw (point 1) in order to tighten the brackets to the pipes.
- D) Fixer les attaches arrières (point 2) à ceux frontal (point 3) avec la vis de fixation (point 1) pour serrer les attaches aux tuyaux.